



**ROSEWOOD BUILDING, GORSUCH PLACE,
LONDON E2**





A light and spacious two bedroom, dual aspect apartment in Rosewood Building, Shoreditch Exchange, a development by Regal Homes.

Situated on the 3rd floor, this apartment comprises two double bedrooms with fitted wardrobes to each bedroom, large open plan living area, balcony with access from each bedroom, fully fitted kitchen with integrated Siemens appliances, luxury bathroom, wood flooring and excellent storage space.

Shoreditch Exchange is well situated for the City of London and is in the heart of the ever popular and vibrant Shoreditch. The development is moments from Hoxton station (0.1 mile), well situated for the City of London and in the heart of Shoreditch. Other benefits include 24 hour concierge, on site gymnasium and private cinema, along with a rooftop terrace.

- 2 Bedrooms
- 1 Bathroom
- 3rd Floor
- Large balcony
- 24 Hour concierge
- On-site leisure facilities including gym & cinema
- Communal roof-terrace
- 0.1 miles from Hoxton over ground Station
- Leasehold
- EPC: B

PRICE
OIEO £850,000

GROSS INTERNAL AREA
704 sq ft (65.4 sq m)

ROSEWOOD BUILDING, SHOREDITCH EXCHANGE
APPROXIMATE GROSS INTERNAL FLOOR AREA 704 SQ.FT (65.4 SQ.M)

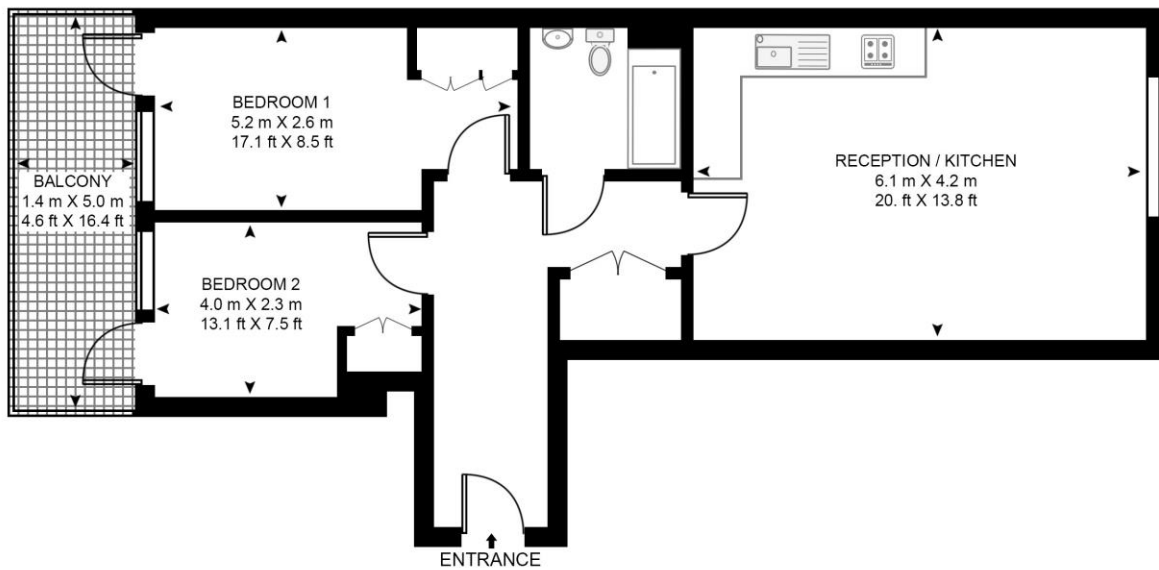

THIRD FLOOR



This floor plan has been defined by the RICS Code of Measurement. This floor plan and all others are for approximate representative purposes only and upon usage is agreed to as such by the client.

WWW: hdvirtualart.com | TEL: 0203.974.1567 | EMAIL: info@hdvirtualart.com

The Walbrook Building
25 Walbrook
London
EC4N 8AF

These particulars are for general information only and do not constitute any part of an offer or contract. All statements contained therein are made without responsibility on the part of the vendors or lessors and are not to be relied upon as statement or representation of fact. Intending purchasers or lessees must satisfy themselves, by inspection, or otherwise, as to the correctness of each of the statements or dimensions contained in these particulars..