



Palmer Road, London SW11

Asking price £704,220 Leasehold







Description

Located moments from Battersea Park, a short stroll over the Thames to Chelsea, adjacent to the iconic Battersea Power Station, Prince of Wales Drive benefits from the heritage of the old and the delights of the new.

This sophisticated and spacious apartment comprises of open plan kitchen reception room leading to private balcony, master bedroom with fitted wardrobes, luxury bathroom, and cloakroom.

The stunning residents facilities include a pool, sauna, steam room, residents roof terrace and concierge.

Access to the northern line extension at Battersea Powerstation and two overground stations are less than 5 minutes away, offering direct connections to Waterloo and Victoria.

- - 1 Bedroom
- - 1 Bathroom
- - Battersea Park
- - Balcony
- - Concierge
- - Spa & Pool
- - 000 sq ft (00 sq m)
- - Unfurnished / Furnished
- - EPC: B

Floorplan

563 sq ft | 52 sq m

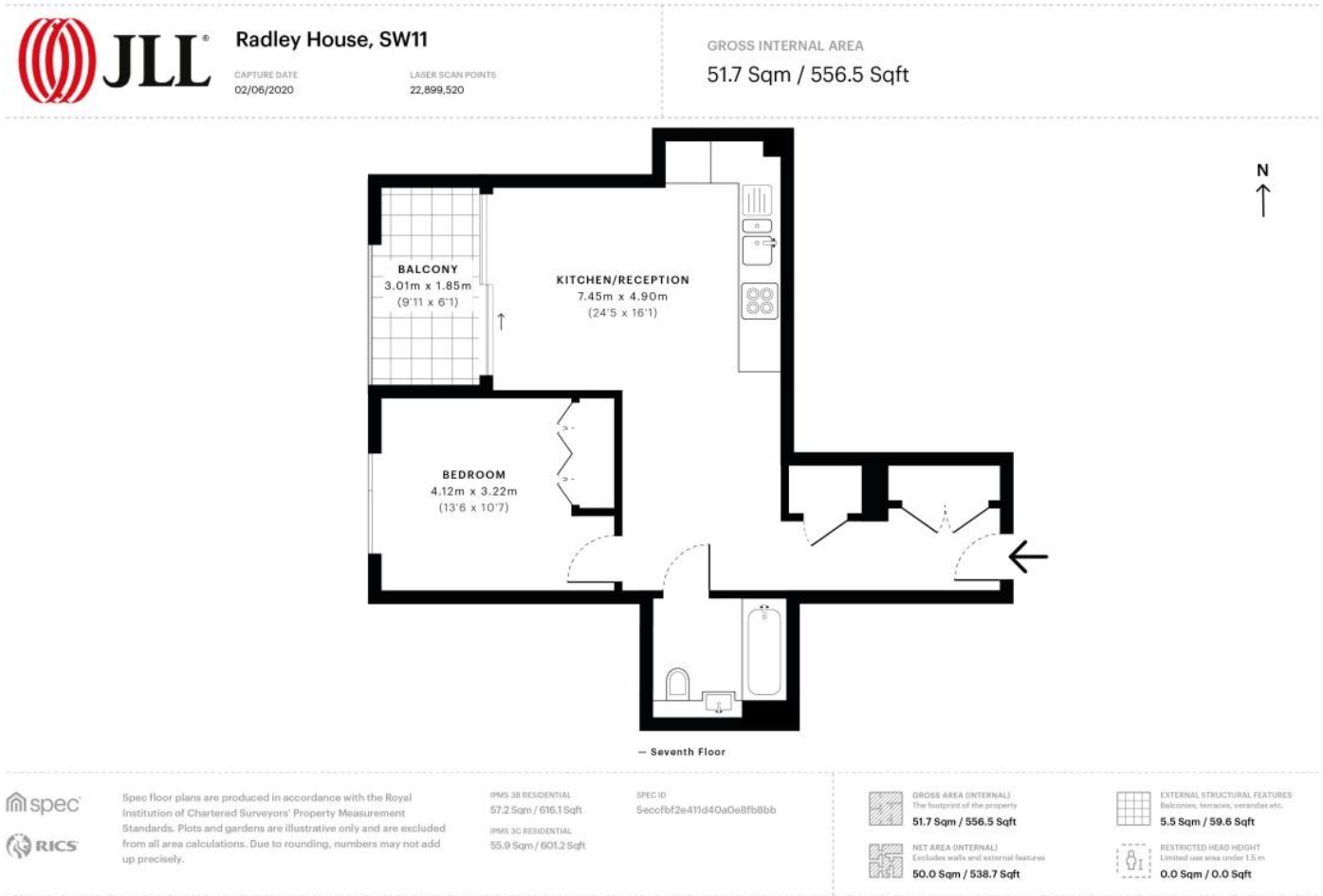

Nine Elms
4 Riverlight Quay,
London SW11 8DG
+4420 3147 1333
nineelms@eu.jll.com

Urban living, your way.

jll.co.uk/residential

© 2019 Jones Lang LaSalle IP, Inc. All rights reserved. All information contained herein is from sources deemed reliable; however, no representation or warranty is made to the accuracy thereof.

