



# Grand Central Apartments, London NW

Price £969 per week - Furnished







## Description

Secure your two-bedroom apartment within Grand Central now. Brand new two-bedroom apartments available to reserve ahead of completion.

Each apartment is finished to the highest standard and comprises an open plan living space, with a stylish and fully integrated kitchen, living area with floor to ceiling windows, two spacious bedrooms with fitted wardrobes, master bedroom with en-suite and a further contemporary bathroom suite with bath and overhead rainfall shower. Each apartment has a private balcony.

Designed by award-winning architects Stiff + Trevillion and inspired by the linear forms and materials of the railway, this is a building that captures the area's forward-looking spirit and iconic industrial past.

Photos are for illustrative purposes only, video are available upon request. Final move dates are subject to completion of each individual property.

Rent is payable on a monthly basis and you may be required to pay more than a month's rent in advance, depending on your circumstances. You will be required to pay a 1 week holding de

- Brand New
- 14th Floor
- Private Balcony
- Concierge Service
- Open-Plan Living
- Wooden Flooring
- Furnished
- Floor to Ceiling Windows
- Close to Kings Cross / St. Pancras Stations
- Council tax: Band F

# Floorplan

sq ft | sq m

## Grand Central Apartments, NW1

Approximate Gross Internal Area  
71.61 sq m / 771 sq ft

( CH = Ceiling Heights )

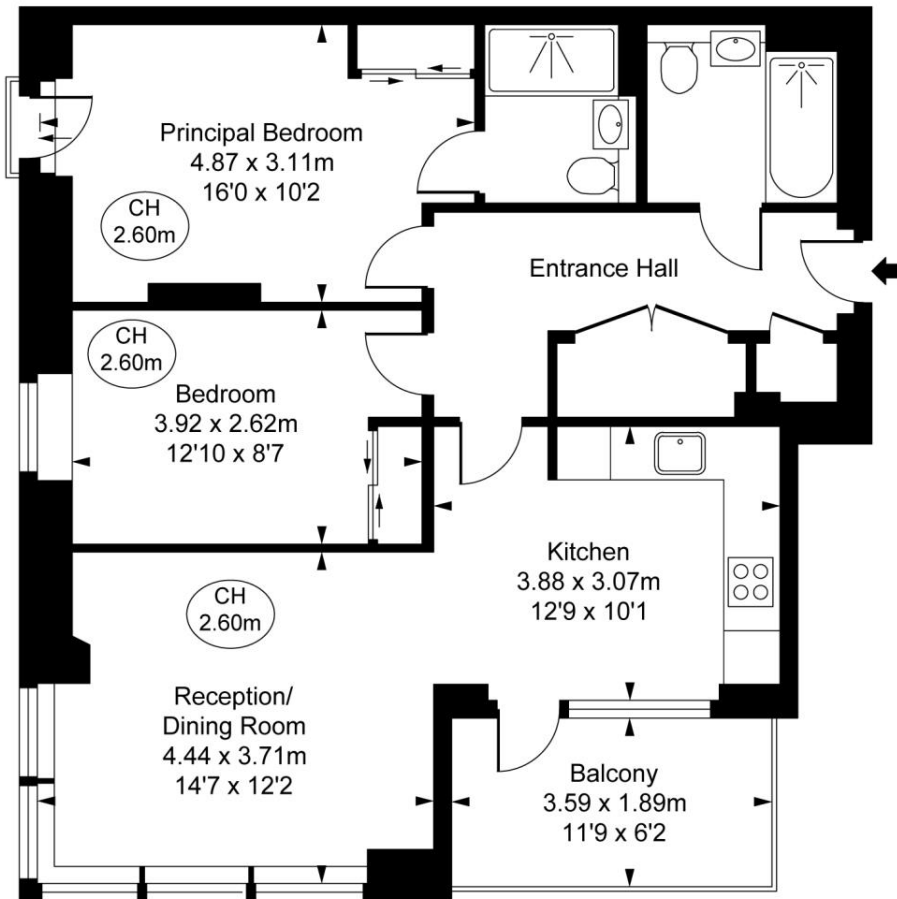

Fourteenth Floor

This plan is not to scale. It is for guidance and not for valuation purposes.  
All measurements and areas are approximate only, and have been prepared in accordance with the current edition of the RICS Code of Measuring Practice.  
© Fulham Performance

Mayfair and Marylebone  
13a St George Street,  
London W1S 2FQ  
+44 207 399 5550  
mayfair@jll.com

*Urban living, your way.*

[jll.co.uk/residential](http://jll.co.uk/residential)

© 2019 Jones Lang LaSalle IP, Inc. All rights reserved. All information contained herein is from sources deemed reliable; however, no representation or warranty is made to the accuracy thereof.

