



## Adenmore Road, London SE6

Guide price £330,000 Leasehold









# Description

A stunning one bedroom apartment in the Catford Green development, backing onto Ladywell Fields this lovely apartment offers fantastic views over the Park while being easily accessible into the main transport hub at Catford for access into Central London and the South Circular.

This lovely apartment offers an abundance of natural light throughout and is furnished to a high standard, it briefly comprises an open plan reception room leading through to the modern kitchen with a range of integrated appliances, spacious double bedroom with built in wardrobe and a great family bathroom.

The property comes to the market with no onward chain, early viewings are highly recommended.

- 1 Bedroom
- 1 Bathroom
- Spacious throughout
- Stunning Park views
- Excellent transport links
- Approx 455 sq ft (42.3sq m)
- No onward chain
- EPC: B



# Floorplan

455 sq ft | 42 sq m

DIXIE COURT, ADENMORE ROAD, SE6  
Approx. gross internal area  
455 Sq Ft. / 42.3 Sq M.

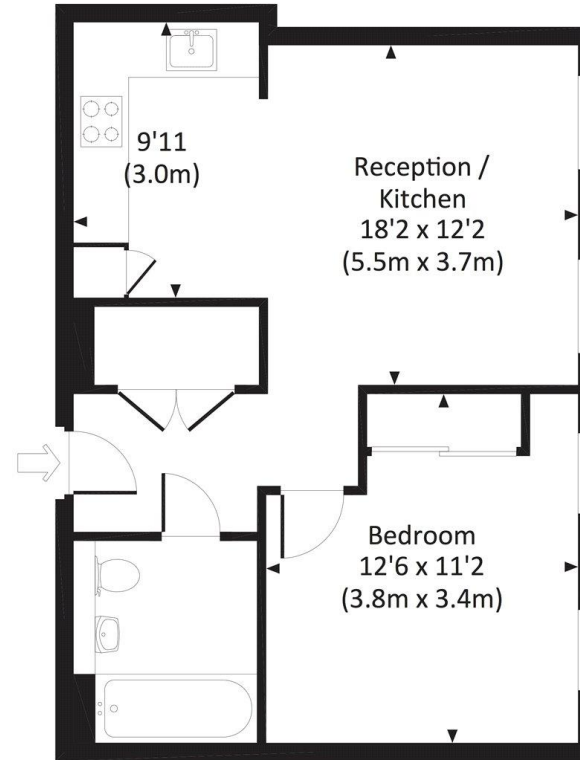

FIRST FLOOR

dpf All measurements have been made in accordance with RICS Code of Measuring Practice which are approximate only and only for illustrative purposes. For the avoidance of doubt, Dowling Jones Design shall not be liable for any reliance on these measurements. © 2017 www.dowlingjones.com 020 7610 9933

Greenwich  
22 College Approach,  
London SE10 9HY  
02088589986  
lettingsgreenwich@eu.jll.com

*Urban living, your way.*

[jll.co.uk/residential](http://jll.co.uk/residential)

© 2019 Jones Lang LaSalle IP, Inc. All rights reserved. All information contained herein is from sources deemed reliable; however, no representation or warranty is made to the accuracy thereof.

