



Station St, London E15

Asking price £515,000 Leasehold







Description

Rare to the market, a 24th floor 1 bedroom apartment spanning over 700 Sqft in one of Stratford most iconic and well connected developments, Unex Tower E15.

Comprising entrance hall with extra large storage cupboard, 29.5 ft kitchen/living area with fully fitted and integrated modern kitchen, bright living space leading to private winter garden and modern fitted bathroom suite.

Located directly opposite Stratford Station, residents benefit being less than a minute walk to one of London's most well connected and busiest stations. You are also just a couple of minutes walk to Stratford Westfield shopping Centre to indulge in retail therapy and a selection of some of London's most well known restaurants.

Unex Tower features a private residents roof terrace with spectacular 360° vistas of London, 24 hour concierge and security service and secured bicycle storage.

- Spacious one bedroom apartment
- 24th floor
- Amazing views
- Leasehold
- Winter garden
- 24hr Concierge
- Approx. 716 sq. ft (66.5 sq. m)
- Approx. 1 minute away from Stratford Station and Westfield Shopping Centre
- Queen Elizabeth Olympic Park on your doorstep
- EPC Rating B

Floorplan

716 sq ft | 67 sq m

UNEX TOWER

APPROXIMATE GROSS INTERNAL FLOOR AREA 716 SQ.FT (66.5 SQ.M)

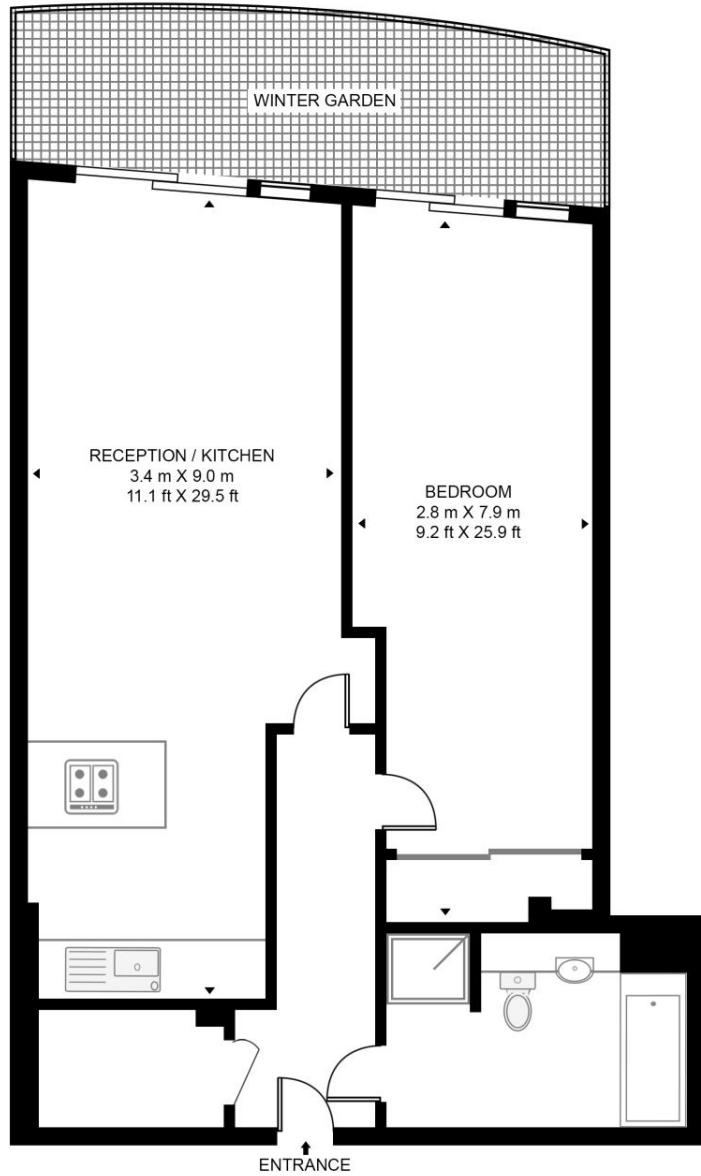

TWENTY FOURTH FLOOR



This floor plan has been defined by the RICS Code of Measurement. This floor plan and all others are for approximate representative purposes only and upon usage is agreed to as such by the client.
WWW: hdvirtualart.com | TEL: 0203.974.1567 | EMAIL: info@hdvirtualart.com

Stratford
5 Station Street,
London E15 1DA
+4420 3147 1500
Lettingsstratford@eu.jll.com

Urban living, your way.

jll.co.uk/residential

© 2019 Jones Lang LaSalle IP, Inc. All rights reserved. All information contained herein is from sources deemed reliable; however, no representation or warranty is made to the accuracy thereof.

