

Rathbone Place, London W1T

Price £850 per week - Furnished

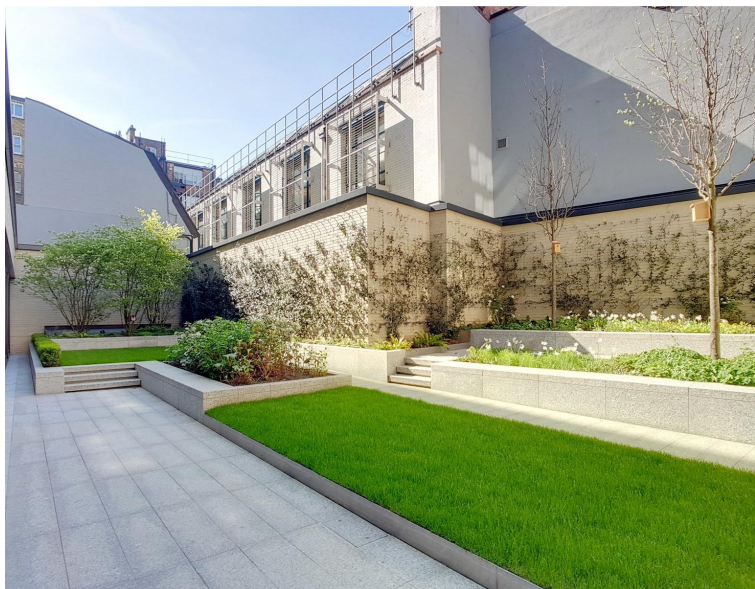





Description

A brand new and stunning apartment located in Great Portland Estates' new development on the fourth floor. The studio property comprises of a bedroom area with built in storage, luxury shower room, reception room and a fully fitted, open plan kitchen with wine cooler and balcony.

Residents will benefit from access to a 24 hour concierge, beautiful gardens, residents' lounge, wine storage and tasting room, screening room, gymnasium, swimming pool, sauna and steam room. Rathbone Square has been designed to offer a tranquil environment, whilst being ideally located moments from Oxford Street.

Situated in the heart of London's West End, ideal for transport links in and around London, with The City and West London being just 10 minutes away via the underground.

As well as paying the rent, you may also be required to make some additional permitted payments. If your tenancy does not qualify as an AST, additional fees may apply. Please visit jll.co.uk/fees for details of fees which may be payable when renting a property

- Studio
- Bathroom
- Balcony
- Swimming pool
- 24 Hour concierge
- Furnished
- Approx. 447 sq ft (41.5 sq m)
- EPC: B

Floorplan

447 sq ft | 42 sq m

Rathbone Square,
Rathbone Place, W1T
Approximate Gross Internal Area
40.51 sq m / 436 sq ft
(CH = Ceiling Heights)

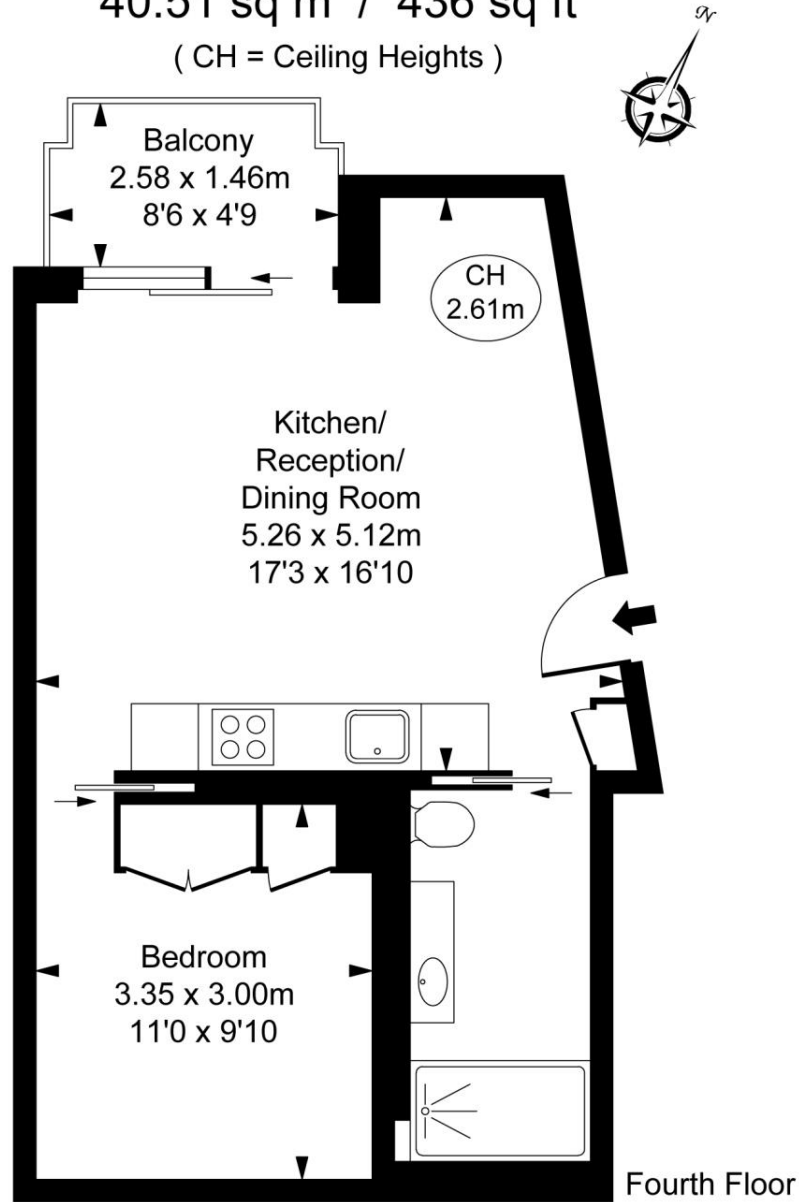

This plan is not to scale. It is for guidance and not for valuation purposes.
All measurements and areas are approximate only, and have been prepared in accordance with the current edition of the RICS Code of Measuring Practice.
© Fulham Performance

Mayfair and Marylebone
JLL, 30 Warwick Street,
London W1B 5NH
+44 207 399 5550
tenancymanagement@eu.jll.c

Urban living, your way.

jll.co.uk/residential

© 2019 Jones Lang LaSalle IP, Inc. All rights reserved. All information contained herein is from sources deemed reliable; however, no representation or warranty is made to the accuracy thereof.

