

Windsor Court

CHELSEA SW3



A light and comfortable pied-à-terre set in the heart of Chelsea and next to "The Green" which has just been sympathetically landscaped.

Windsor Court is a small block of flats which share a caretaker with its sister building opposite and is situated at the northern end of Jubilee Place.



Accommodation

- Entrance hall
- Reception room
- Kitchen
- Bedroom
- Bathroom en suite
- Communal central heating and hot water
- Lift
- Caretaker



Price £925,000
 Tenure Leasehold 125 years
 Service Charge £3,60794 plus the reserve fund £1,250 for the half year to 28/09/2023
 Ground Rent Peppercorn
 Local Authority Royal Borough of Kensington and Chelsea
 EPC Rating C
 Council Tax Band D (£914.14 per annum)

Approximate Gross Internal Area
 606 sq ft / 56.30 sq m

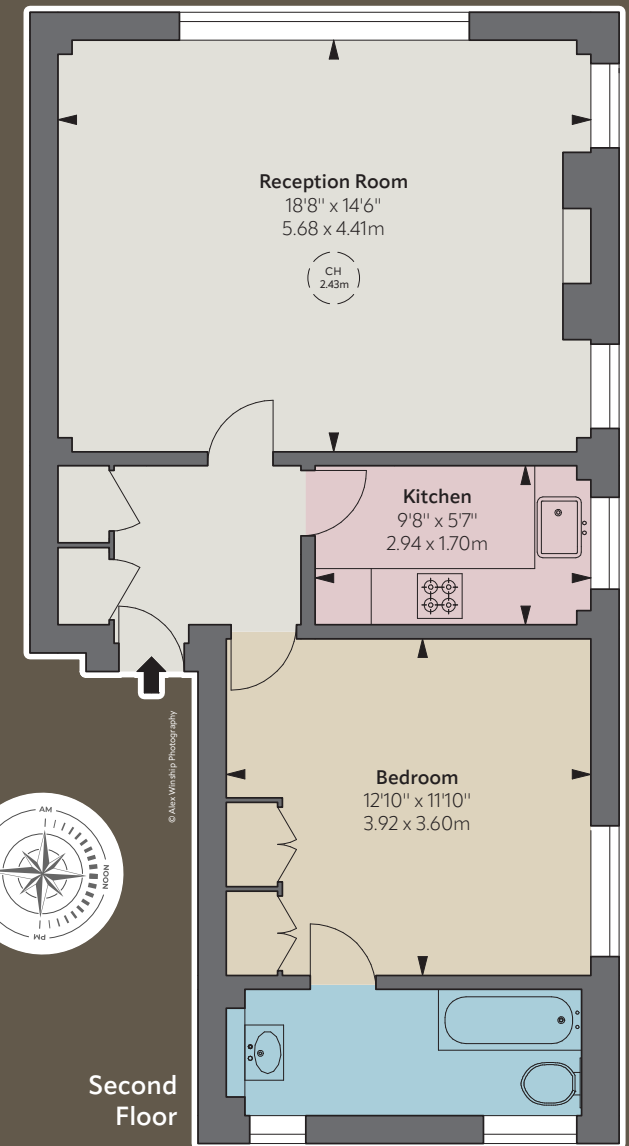

THE BROCHURE ALEX WINSHIP

These particulars are for general information only and do not constitute any part of an offer or contract. All statements contained therein are made without responsibility on the part of the vendors or lessors and are not to be relied upon as statement or representation of fact. Intending purchasers or lessees must satisfy themselves, by inspection, or otherwise, as to the correctness of each of the statements or dimensions contained in these particulars. This floorplan is for guidance only and not for valuation purposes. 21/04/23 JLL-230420-03MS

Floorplan for guidance only, not to scale or valuations purposes. It must not be relied upon as a statement of fact. All measurements and areas are approximate and have been prepared in accordance with the current edition of the RICS Code of Measuring Practice.

Savills Knightsbridge
 knightsbridge_sales@savills.com
 020 7581 5234

Savills Chelsea
 chelsea@savills.com
 020 7578 9000
 savills.co.uk



JLL Knightsbridge
 knightsbridge@eu.jll.com | 020 7306 1600
 JLL Chelsea
 chelsea@eu.jll.com | 020 7399 5010
 jll.co.uk/residential