



Rathbone Place, London W1T

Price £875 per week - Furnished







Description

A stylish sixth floor apartment (with lift) in the very sought after Rathbone Square development. The apartment comprises a reception room with bedroom area, one bathroom and an open plan kitchen. Rathbone Square benefits from excellent residents' facilities, including a swimming pool, spa, cinema room, 24 hour concierge and gym, as well as an excellent location close to Oxford Circus, Regent Street and the world class shops and restaurants of Mayfair.

As well as paying the rent, you may also be required to make permitted payments. Please visit jll.co.uk/fees for details of fees which may be payable when renting a property. If your tenancy does not qualify as an AST, additional fees may apply.

- Reception room with bedroom area
- One bathroom
- Open plan kitchen
- Sixth floor
- Lift
- 24 hour concierge
- Swimming pool and spa
- Residents' gym
- Cinema room
- Approx. 447 sq ft (41 sq m)

Floorplan

447 sq ft | 42 sq m

Rathbone Square,
Rathbone Place, W1T
Approximate Gross Internal Area
40.31 sq m / 434 sq ft
(CH = Ceiling Heights)

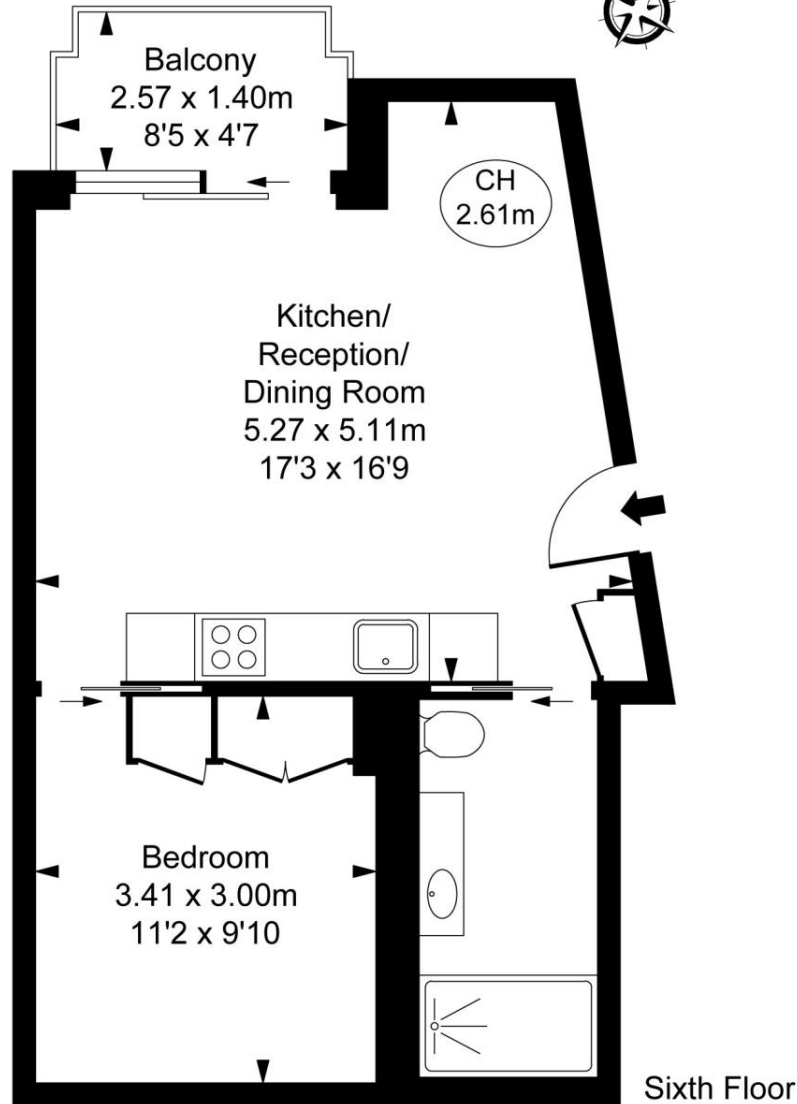

This plan is not to scale. It is for guidance and not for valuation purposes.
All measurements and areas are approximate only, and have been prepared in accordance with the current edition of the RICS Code of Measuring Practice.
© Fulham Performance

Mayfair and Marylebone
JLL, 30 Warwick Street,
London W1B 5NH
+44 207 399 5550
tenancymanagement@eu.jll.c

Urban living, your way.

jll.co.uk/residential

© 2019 Jones Lang LaSalle IP, Inc. All rights reserved. All information contained herein is from sources deemed reliable; however, no representation or warranty is made to the accuracy thereof.

