



**EARLSWOOD STREET,
GREENWICH, SE10**





Located in the heart of East Greenwich, this beautifully presented two bedroom, period end-of-terrace house which boasts period features, and is well located for Maze Hill mainline station which offers direct links to London Cannon Street, City and the rest of Central London.

The versatile accommodation comprises a large fitted kitchen with access to a private courtyard garden. An open plan lounge and dining room area which also has access to the rear garden via the side return. On the first floor, there are two good sized bedrooms and a family bathroom.

Greenwich Park is a short walk away and is the perfect place for a stroll no matter what the season. There's also an enormous children's playground where you can let the kids run around. You also have access to the Royal Observatory and have a look at the view back across Docklands, the City and the rest of Central London. Greenwich Town centre is also on your doorstep with its fantastic choice of restaurants, pubs and famous market.

The property is offered to the market with no onward chain, so early viewings are highly recommended.

- 2 Double bedrooms
- 1 Bathroom
- End of terrace period house
- Rear courtyard garden
- Beautifully presented throughout
- Original period features
- Close to Maze Hill mainline station
- Walk to Greenwich Park
- No onward chain
- EPC: D

PRICE

Asking Price £729,950

GROSS INTERNAL AREA

936.46 sq ft (87 sq m)

LOCAL AUTHORITY

Royal Borough of Greenwich

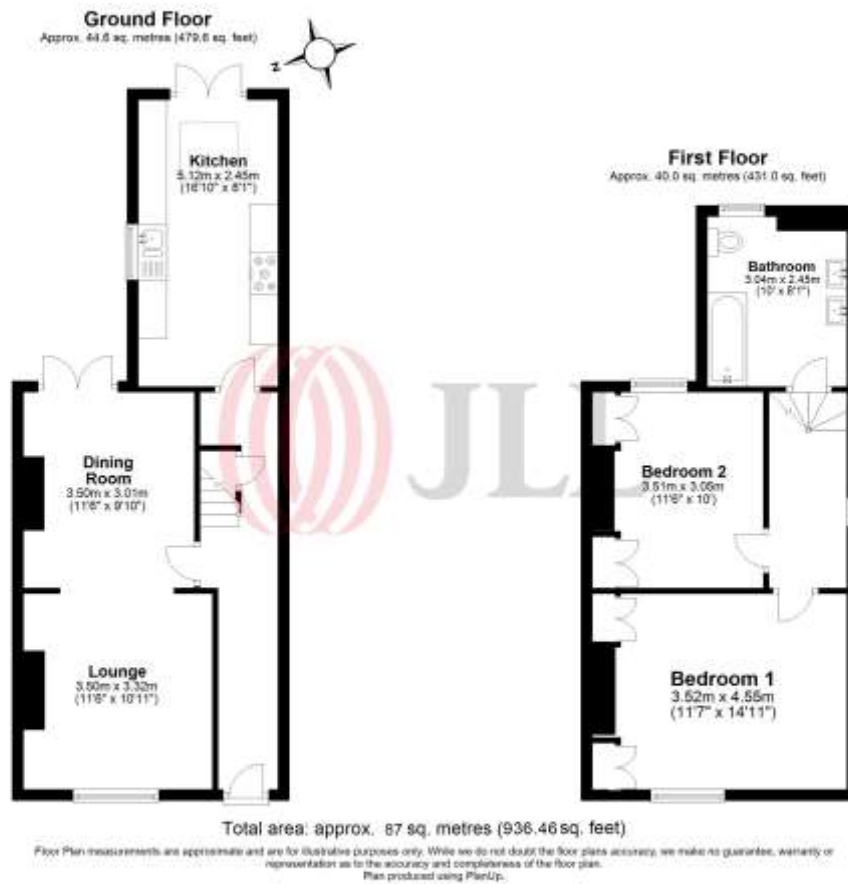

22 College Approach
Greenwich
London
SE10 9HY

These particulars are for general information only and do not constitute any part of an offer or contract. All statements contained therein are made without responsibility on the part of the vendors or lessors and are not to be relied upon as statement or representation of fact. Intending purchasers or lessees must satisfy themselves, by inspection, or otherwise, as to the correctness of each of the statements or dimensions contained in these particulars..