



Deals Gateway, London SE13

Price £1,650 per month - Furnished





Description

A lovely one bedroom apartment located perfectly for a short commute to Canary Wharf and The City. Situated in the popular SE8 development with concierge service, gym, swimming pool and allocated parking.

The property comprises spacious living area with balcony, space for dining, open plan kitchen with appliances. A large double bedroom with wardrobes. Family bathroom with bath and shower. Further benefit included allocated parking and direct access to Deptford Bridge DLR station. The property is available immediately, offered furnished.

As well as paying the rent, you may also be required to make some additional permitted payments. If your tenancy does not qualify as an AST, additional fees may apply. Please visit jll.co.uk/fees for details of fees which may be payable when renting a property.



- Apartment
- One bedroom
- Furnished
- Close proximity to Deptford Bridge DLR
- Gym & swimming pool
- Allocated parking
- Approx. 466 sq ft (43 sq m)
- EPC: B

Floorplan

466 sq ft | 43 sq m

COLORADO BUILDING, SE13

Approx. gross internal area
466 Sq Ft. / 43.3 Sq M.

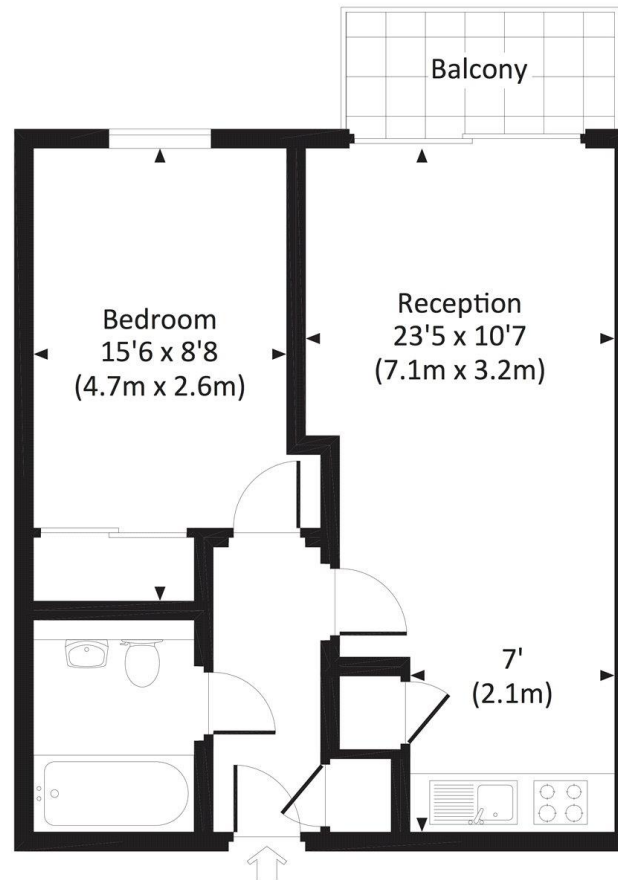

EIGHTH FLOOR

dp All measurements have been made in accordance with RICS Code of Measuring Practice which are approximate only and only for illustrative purposes. For the avoidance of doubt, Dowling Jones Design shall not be liable for any reliance on these measurements. © 2017 www.dowlingjones.com 020 7610 9933

Greenwich
22 College Approach,
London SE10 9HY
02088589986
lettingsgreenwich@eu.jll.com

Urban living, your way.

jll.co.uk/residential

© 2019 Jones Lang LaSalle IP, Inc. All rights reserved. All information contained herein is from sources deemed reliable; however, no representation or warranty is made to the accuracy thereof.

