



**THE PLAZA, VANBRUGH HILL,
GREENWICH, SE10**





This bright first floor one bedroom apartment with its high ceilings and large windows offers generous living space and is located within a popular converted cinema building in East Greenwich.

The accommodation comprises living room/open plan kitchen, master bedroom, bathroom and secure allocated parking. The property features a communal roof terrace offering some fine views, and a resident's gym.

The apartment is conveniently located for access to Maze Hill main line station, and the shops, bars and restaurants of central Greenwich are a short walk away.

The property benefits from no onward chain, early viewings are highly recommended.

- 1 Double Bedroom
- 1 Bathroom
- First Floor
- Light throughout
- Converted cinema building
- Residents' gym
- Communal roof terrace
- Parking space
- East Greenwich location
- Walk to Maze Hill mainline station
- No onward chain
- EPC: C

PRICE

Asking Price OIEO £350,000

GROSS INTERNAL AREA

586.5 sq ft (54.5 sq m)

LOCAL AUTHORITY

Royal Borough of Greenwich

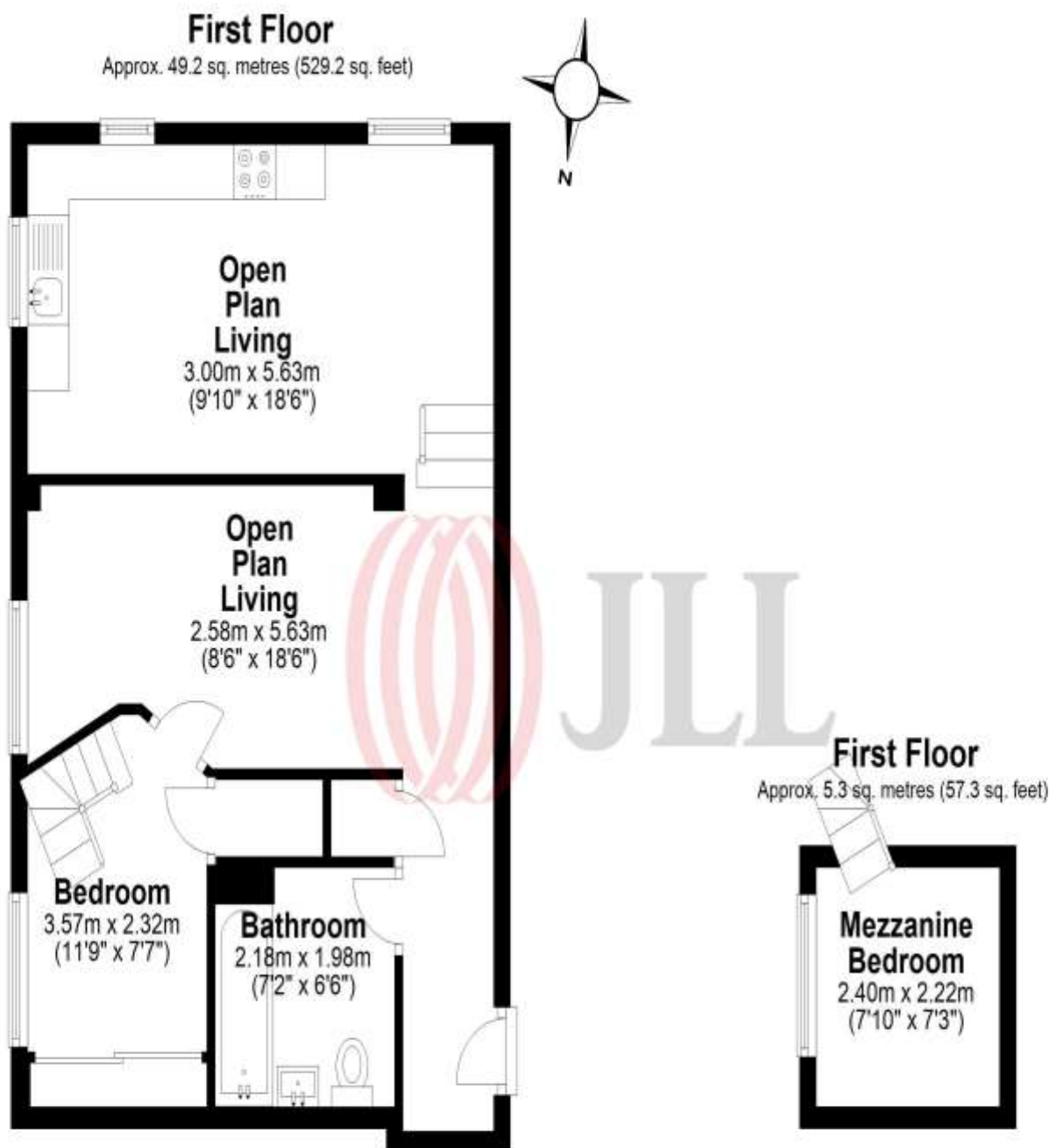

Total area: approx. 54.5 sq. metres (586.5 sq. feet)

Floor Plan measurements are approximate and are for illustrative purposes only. While we do not doubt the floor plans accuracy, we make no guarantee, warranty or representation as to the accuracy and completeness of the floor plan.
Plan produced using PlanUp.

22 College Approach
Greenwich
London
SE10 9HY

These particulars are for general information only and do not constitute any part of an offer or contract. All statements contained therein are made without responsibility on the part of the vendors or lessors and are not to be relied upon as statement or representation of fact. Intending purchasers or lessees must satisfy themselves, by inspection, or otherwise, as to the correctness of each of the statements or dimensions contained in these particulars..