



## Courtfield Road, London SW7

Guide price £1,150,000 Share of Freehold





# Description

A superb two double bedroom lateral apartment on the second floor (with lift) in this attractive period building with stunning views over the garden square.

The flat has great transport links and ideally located for reaching central London, with Gloucester Road tube station only a few minutes' walk away. From here you can catch the Circle, District and Piccadilly line trains.

- Share of freehold
- 2 Bedrooms
- Bathroom
- Reception room
- Kitchen
- Lift
- EPC: C



## Courtfield Road, SW7

APPROX. GROSS INTERNAL AREA \*  
647 Sq Ft - 60.11 Sq M

This floorplan is for GUIDANCE ONLY and NOT FOR VALUATION purposes.

Key :  
CH - Ceiling Height

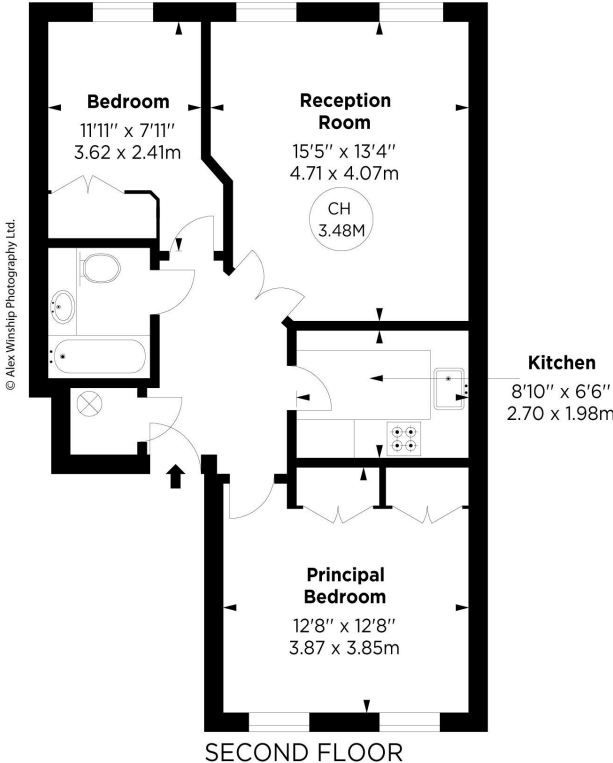

Knightsbridge  
174 Brompton Road,  
London SW3 1HP  
+4420 7306 1600  
lettingsknightsbridge@eu.jll.co

*Urban living, your way.*

[jll.co.uk/residential](http://jll.co.uk/residential)  
© 2019 Jones Lang LaSalle IP, Inc. All rights reserved. All information contained herein is from sources deemed reliable; however, no representation or warranty is made to the accuracy thereof.

