



**SEREN PARK GARDENS,
BLACKHEATH, SE3**





Fantastic one double bedroom apartment situated on the 8th floor of this modern gated development where you will benefit from concierge services, private underground parking and conveniently located 2-minute walk to Maze Hill station, where you will be into London Bridge within just 15 minutes.

The accommodation comprises entrance hall with ample storage, large living room leading to balcony where you can enjoy panoramic views across the London skyline, modern and fully integrated kitchen, double bedroom and modern bathroom suite.

The property is well located for Greenwich Park, Greenwich Market and various local shops/boutiques and bars/restaurants offer an abundance of choice for anyone looking to move in.

Early viewings are highly recommended.

- 2 Double bedroom
- 1 Bathroom
- 8th Floor modern apartment
- Balcony
- Close to mainline station
- Parking
- Leasehold (112 years)
- No onward chain
- EPC: B

PRICE

OIEO £380,000

GROSS INTERNAL AREA

512.5 sq ft (47.6 sq m)

LOCAL AUTHORITY

Royal Borough of Greenwich

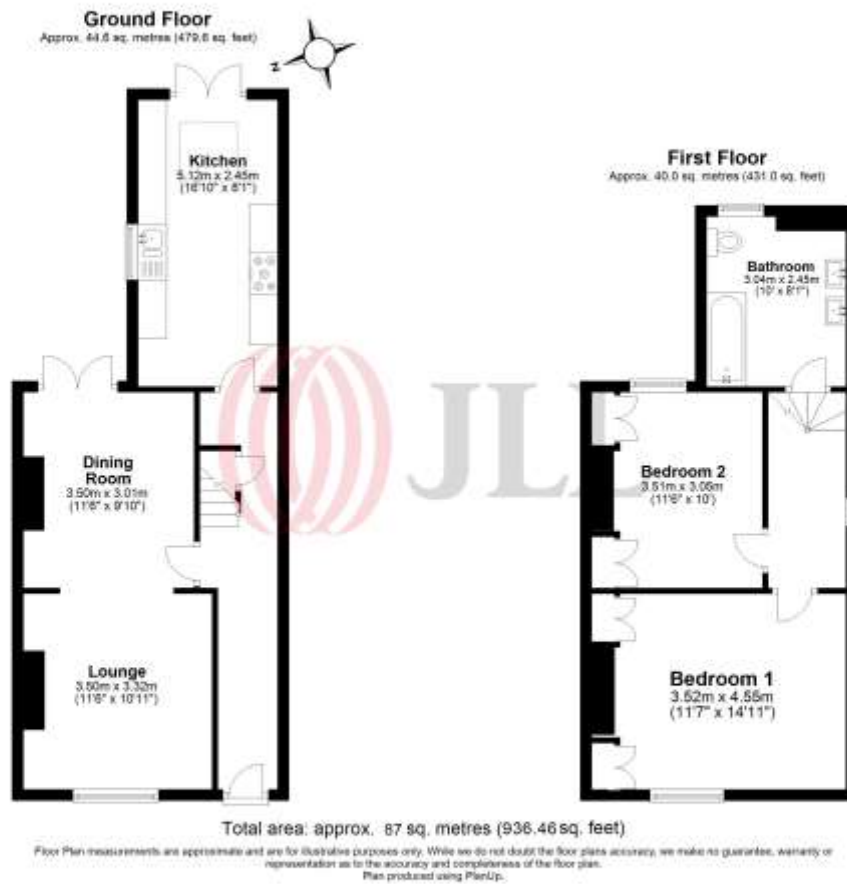

22 College Approach
Greenwich
London
SE10 9HY

These particulars are for general information only and do not constitute any part of an offer or contract. All statements contained therein are made without responsibility on the part of the vendors or lessors and are not to be relied upon as statement or representation of fact. Intending purchasers or lessees must satisfy themselves, by inspection, or otherwise, as to the correctness of each of the statements or dimensions contained in these particulars..