



UNEX TOWER, STATION STREET, E15





Extra large and ultra modern 1 bedroom apartment situated on the 23rd floor and spanning 716 Sq ft in one of Stratford most iconic and well connected developments, Unex Tower E15.

Comprising entrance hall with extra large storage cupboard, 29.5 ft kitchen/living area with fully fitted and integrated modern kitchen, bright living space leading to private winter garden and modern fitted bathroom suite.

Located directly opposite Stratford Station, residents benefit being less than a minute walk to one of London's most well connected and busiest stations. You are also just a couple of minutes walk to Stratford Westfield shopping Centre to indulge in retail therapy and a selection of some of London's most well known restaurants.

Unex Tower features a private residents roof terrace with spectacular 360° vistas of London, 24 hour concierge and security service and secured bicycle storage.

PRICE

OIRO £480,000

GROSS INTERNAL AREA

Approx. 716sq. ft (66.5 sq. m)

- 1 Bedroom
- 1 Bathroom
- 23rd floor
- Ample Storage
- Panoramic views
- Leasehold
- Large Winter garden
- 24hr Concierge
- Approx. 716 sq. ft (66.5 sq. m)
- Approx. 1 minute from Stratford Station and Westfield Shopping Centre
- Queen Elizabeth Olympic Park on your doorstep
- EPC Rating B

UNEX TOWER

APPROXIMATE GROSS INTERNAL FLOOR AREA 716 SQ.FT (66.5 SQ.M)

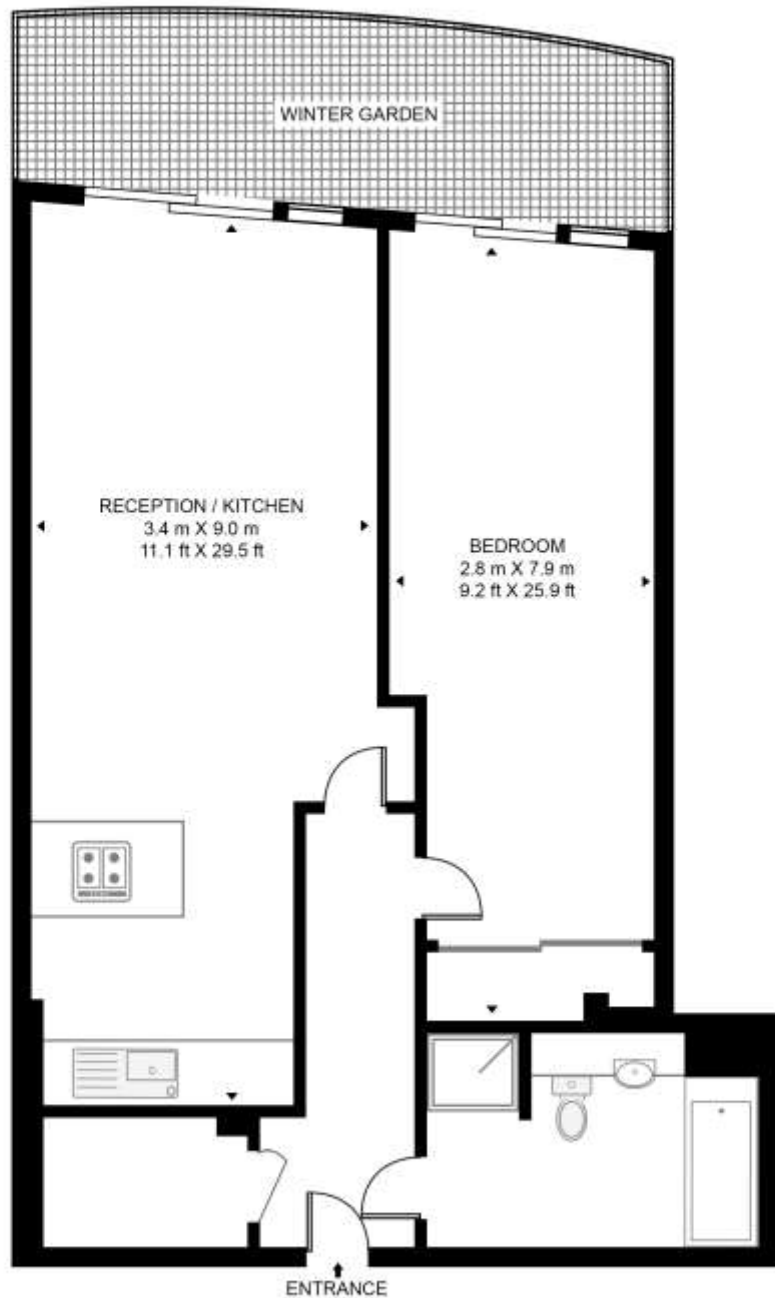

TWENTY FOURTH FLOOR



HDVA

This floor plan has been defined by the RICS Code of Measurement. This floor plan and all others are for approximate representative purposes only and upon usage is agreed to as such by the client.

WWW: hdvirtualart.com | TEL: 0203 974 1567 | EMAIL: info@hdvirtualart.com

Unex Tower
5 Station Street
London
E15 1DA

These particulars are for general information only and do not constitute any part of an offer or contract. All statements contained therein are made without responsibility on the part of the vendors or lessors and are not to be relied upon as statement or representation of fact. Intending purchasers or lessees must satisfy themselves, by inspection, or otherwise, as to the correctness of each of the statements or dimensions contained in these particulars..