

Townmead Road, London SW6

Price £475 per week - Furnished

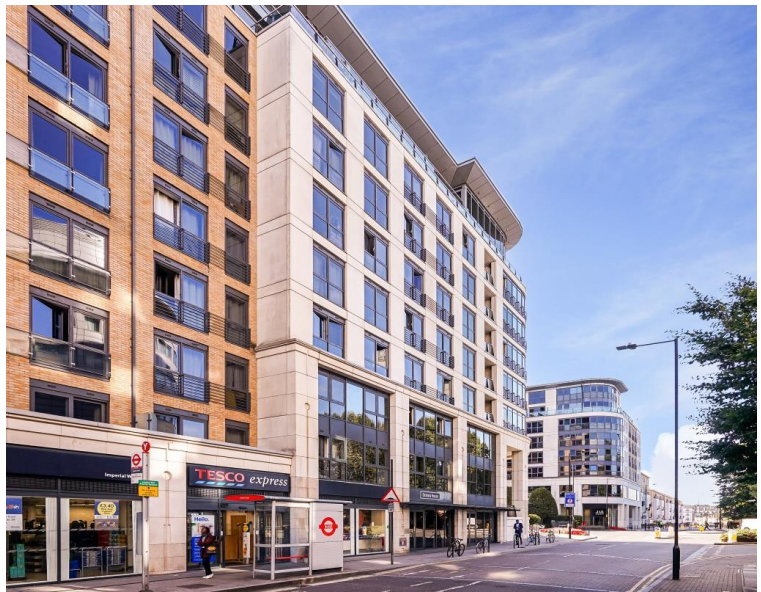





Description

This property is located in the popular Imperial Wharf, London SW6 development for rent. The Manhattan style apartment is a lovely studio with a brand-new bathroom and modern kitchen. Added benefits include 24-hour concierge and an exclusive health and fitness suite. Good transport connections bring Octavia House within easy reach of the fashionable areas of Chelsea and King's Road.

As well as paying the rent, you may also be required to make some additional permitted payments. If your tenancy does not qualify as an AST, additional fees may apply. Please visit jll.co.uk/fees for details of fees which may be payable when renting a property.

- Studio
- Modern kitchen
- Brand new bathroom
- Furnished
- 24 hour concierge
- Health and fitness suite

Floorplan

296 sq ft | 28 sq m

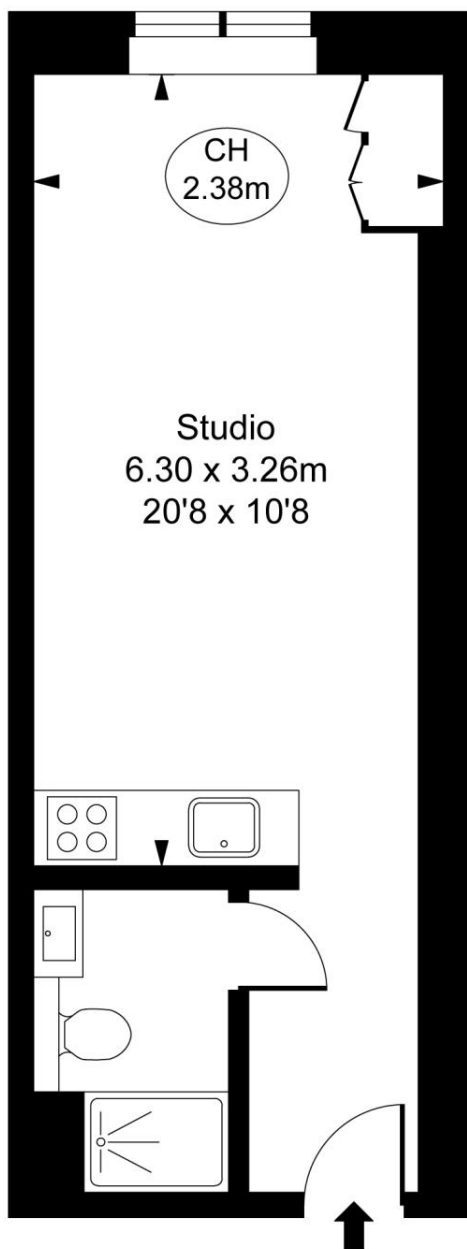

Octavia House,
Townmead Road, SW6
Approximate Gross Internal Area
27.48 sq m / 296 sq ft
(CH = Ceiling Heights)



Second Floor

This plan is not to scale. It is for guidance and not for valuation purposes.
All measurements and areas are approximate only, and have been prepared in accordance with the current edition of the RICS Code of Measuring Practice.
© Fulham Performance

Knightsbridge
174 Brompton Road,
London SW3 1HP
+4420 7306 1600
lettingsknightsbridge@eu.jll.co

Urban living, your way.

jll.co.uk/residential

© 2019 Jones Lang LaSalle IP, Inc. All rights reserved. All information contained herein is from sources deemed reliable; however, no representation or warranty is made to the accuracy thereof.

