



## Townmead Road, London SW6

Price £450 per week - Furnished





# Description

A stunning Manhattan styled fourth floor apartment (with lift) in this award winning waterside development. The property consists of one double bedroom, one bathroom, reception room and a fully fitted, open plan kitchen. Further benefits include wooden flooring, comfort cooling, a balcony and use of the development's exclusive health and fitness suite. The area offers an excellent array of shops and restaurants as well as great transport links with Imperial Wharf train station connecting north towards West Brompton and south to Clapham Junction.

As well as paying the rent, you may also be required to make some additional permitted payments. If your tenancy does not qualify as an AST, additional fees may apply. Please visit [jll.co.uk/fees](http://jll.co.uk/fees) for details of fees which may be payable when renting a property.

- One bedroom
- Reception
- Bathroom
- Kitchen
- Fourth floor
- Furnished
- Balcony
- Approx. 510 sq ft (47.4 sq m)
- EPC: B

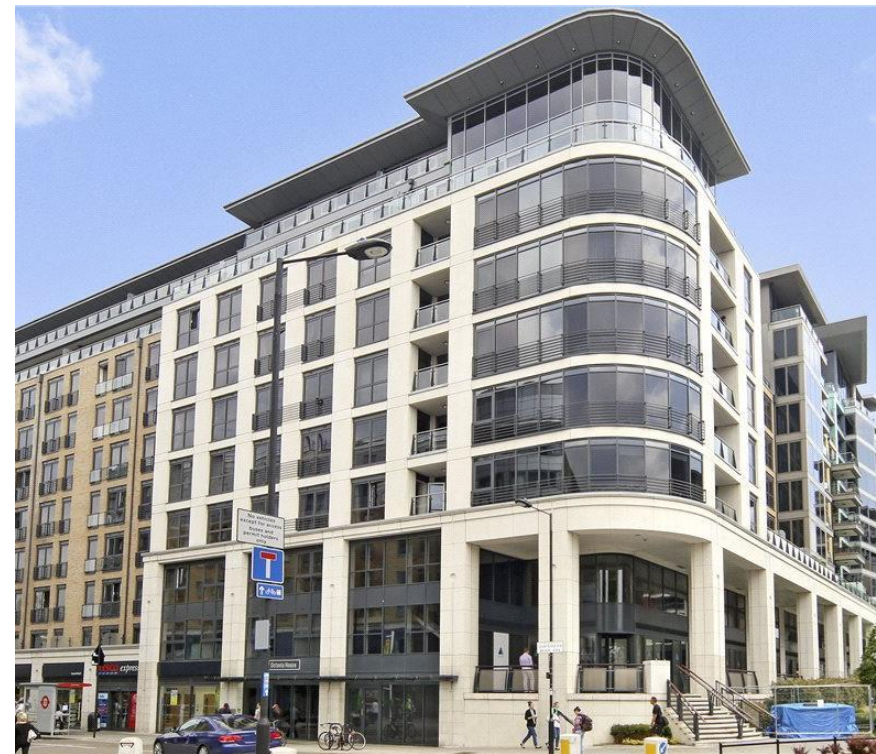

# Floorplan

510 sq ft | 47 sq m

Approx. gross internal area  
510 Sq Ft. / 47.4 Sq M.

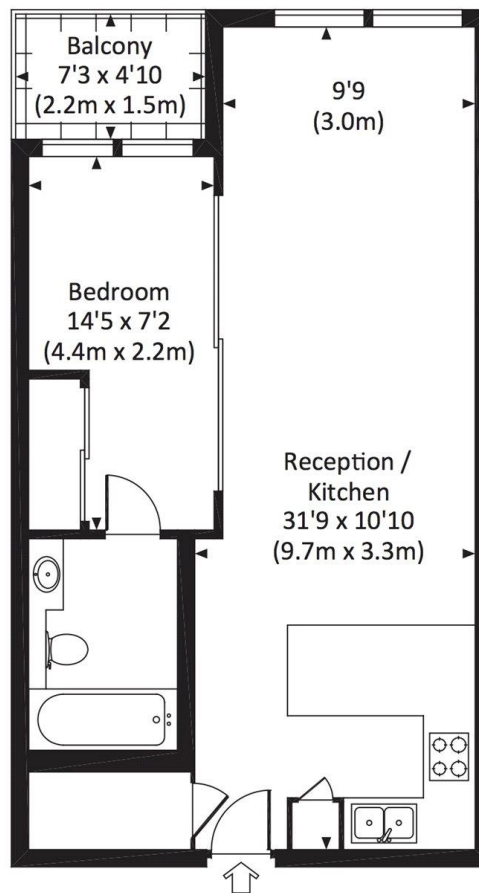

FOURTH FLOOR

dpf All measurements have been made in accordance with RICS Code of Measuring Practice which are approximate only and only for illustrative purposes. For the avoidance of doubt, Dowling Jones Design shall not be liable for any reliance on these measurements. © 2015 www.dowlingjones.com 020 7610 9933

Kensington  
387 Kensington High Street,  
London W14 8QA  
+4420 7087 5696  
lettingskensington@eu.jll.com

*Urban living, your way.*

[jll.co.uk/residential](http://jll.co.uk/residential)

© 2019 Jones Lang LaSalle IP, Inc. All rights reserved. All information contained herein is from sources deemed reliable; however, no representation or warranty is made to the accuracy thereof.

