



Orlop Street, Greenwich, London SE10 9AB



## Orlop Street, Greenwich, London, SE10

### Leasehold

***An excellent opportunity to purchase this quaint one bedroom apartment with garden located in a sought after no-through road in East Greenwich***

### Key Features

- 1 Double bedroom
- 1 Bathroom
- Ground floor
- Garden
- Neutral tones throughout
- Popular location
- Close to Maze Hill station
- EPC: D

---

The accommodation comprises entrance hall with built in cupboard, good sized reception room with opens onto a fully fitted kitchen, double bedroom with fitted wardrobes and a family size shower room. The property also benefits from a garden to front.

Orlop Street is conveniently located for access to Maze Hill main line station, the Royal Park, and the lovely river walk, whilst the shops, bars and restaurants of central Greenwich are a short walk away.

Early viewings are highly recommended.









# Orlop Street, London, SE10

Approximate Area = 553 sq ft / 51.4 sq m

For identification only - Not to scale

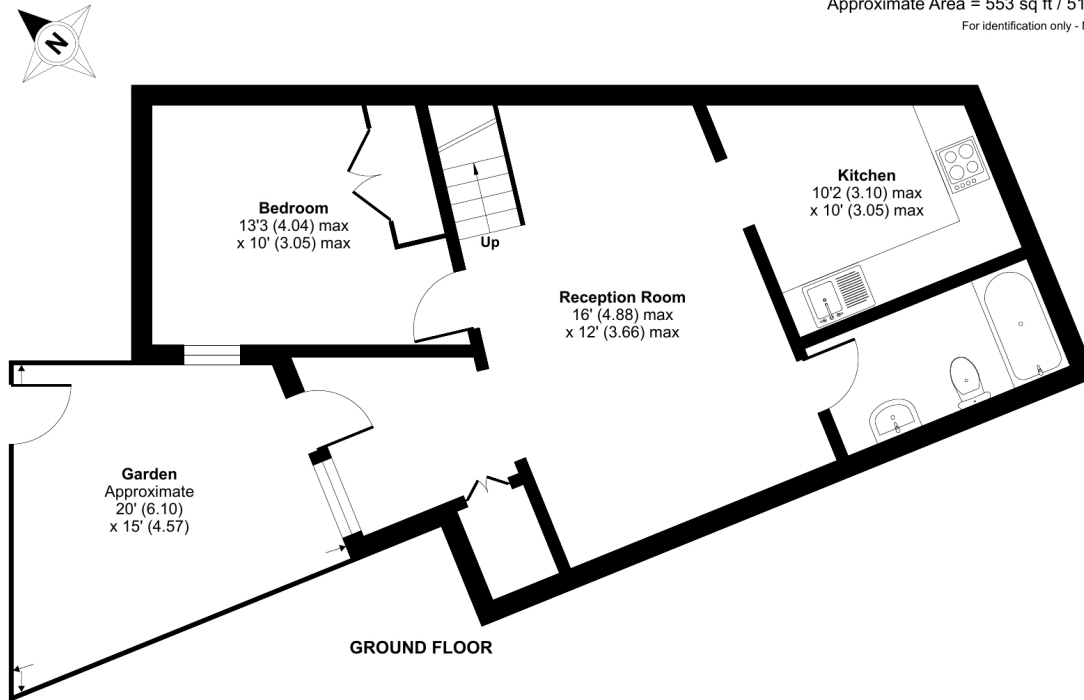

Floor plan produced in accordance with RICS Property Measurement Standards incorporating International Property Measurement Standards (IPMS2 Residential). © rlxhocom 2023. Produced for JLL Residential. REF: 1060705

22 College Approach, Greenwich, London,  
SE10 9HY

Sales, Lettings & Property Management

Tel: 020 8858 9986

[residential.jll.co.uk](https://residential.jll.co.uk)

