



Sloane Street, London SW1X

Price £1,100 per week - Furnished, Unfurnished





Description

A wonderful fourth floor flat (with lift) in this much sought after portered building moments from the shops and amenities of Knightsbridge and Sloane Street.

The property consists of master bedroom with en suite bathroom, second double bedroom, one shower room, a double reception room and a modern kitchen dining area. The apartment is presented to a very high standard and benefits from wooden flooring throughout.

As well as paying the rent, you may also be required to make some additional permitted payments. If your tenancy does not qualify as an AST, additional fees may apply. Please visit jll.co.uk/fees for details of fees which may be payable when renting a property.

- 2 Bedrooms
- 2 Bathrooms
- Guest cloakroom
- Fourth floor (with lift)
- Porter
- Approx. 1287 sq ft (119 sq m)
- EPC: E



Knightsbridge Court, SW1

APPROX. GROSS INTERNAL AREA *
1287 Sq Ft - 119.56 Sq M

This floorplan is for GUIDANCE ONLY and NOT FOR VALUATION purposes.

Key :
CH - Ceiling Height

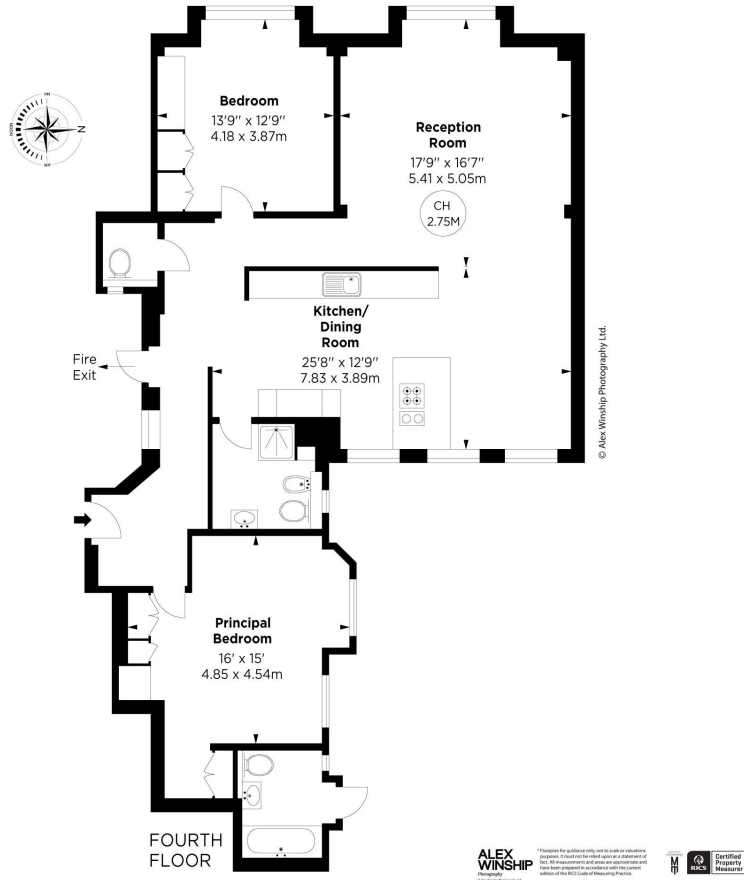

Knightsbridge
Wood Wharf,
London E14 5GX
+4420 7306 1600
lettingsknightsbridge@eu.jll.co

Urban living, your way.

jll.co.uk/residential

© 2019 Jones Lang LaSalle IP, Inc. All rights reserved. All information contained herein is from sources deemed reliable; however, no representation or warranty is made to the accuracy thereof.

