

**Central St Giles Piazza, London WC2H**  
Price £650 per week - Furnished





## Description

A stunning fourth floor flat (with lift) in this award-winning development in Central St Giles. The property consists of one double bedroom, one shower room, reception room and a fully fitted, open plan kitchen. Further benefits include wooden flooring, comfort cooling and 24-hour concierge.

Central St Giles is conveniently located for the excellent shops, restaurants and transport facilities of Covent Garden, Tottenham Court Road and Holborn.

As well as paying the rent, you may also be required to make some additional permitted payments. If your tenancy does not qualify as an AST, additional fees may apply. Please visit [jll.co.uk/fees](http://jll.co.uk/fees) for details of fees which may be payable when renting a property.

- Modern Apartment
  - Open-plan Kitchen
  - 24hr Concierge Service
  - Furnished
  - Wooden Flooring
  - Comfort Cooling
  - Lift Access
  - Close to Covent Garden
-

# Floorplan

412 sq ft | 38 sq m

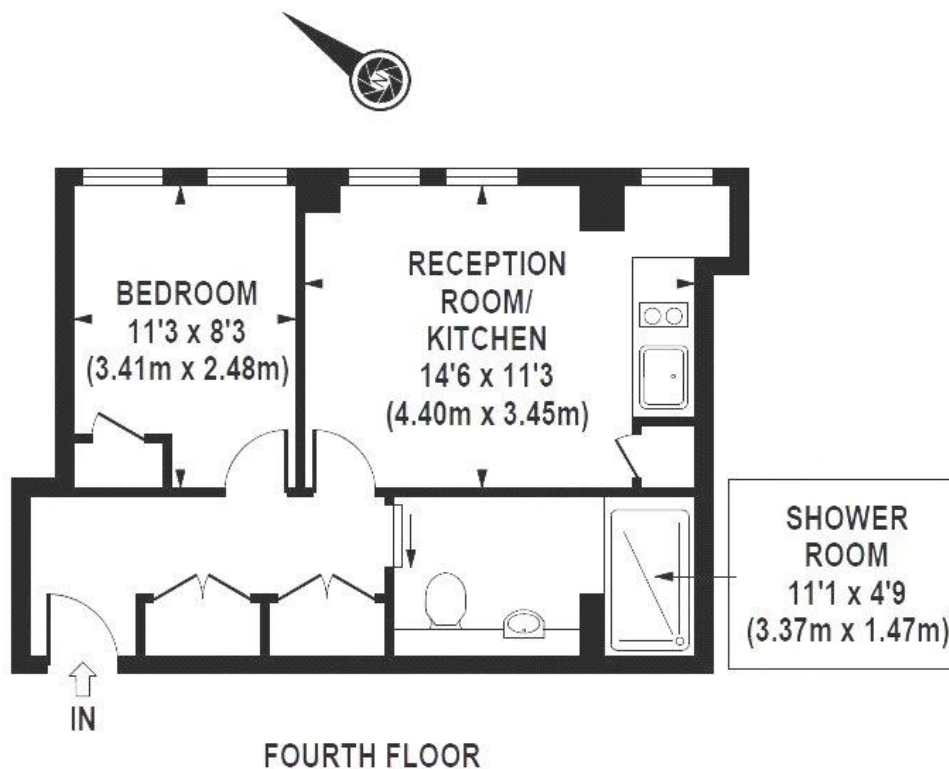

APPROX. GROSS INTERNAL AREA 412 sq.ft / 38.27 sq.m