



Bellville House, Norman Road, Greenwich, London SE10 9FX



Bellville House, Norman Road, London, SE10

Leasehold

A fantastic one bedroom apartment on the 7th floor close to Greenwich mainline and DLR stations.

Key Features

- 1 Double bedroom
- 1 Bathroom
- 7th Floor apartment
- Balcony
- Open plan kitchen / reception
- Close to mainline and DLR
- No onward chain
- EPC:



A fantastic one bedroom apartment on the 7th floor close to Greenwich mainline and DLR stations.

The apartment offers a spacious, light and airy living reception room / kitchen area which leads to a private balcony. Large master bedroom with built-in wardrobes and a family bathroom.

The development has been built to a high specification with high quality fixtures/fittings throughout. The property resides on the same road as Greenwich DLR and mainline train station with easy access to Canary Wharf and the City.

Early viewings are highly recommended.









Norman Road, London, SE10

Approximate Area = 557 sq ft / 51.7 sq m

For identification only - Not to scale

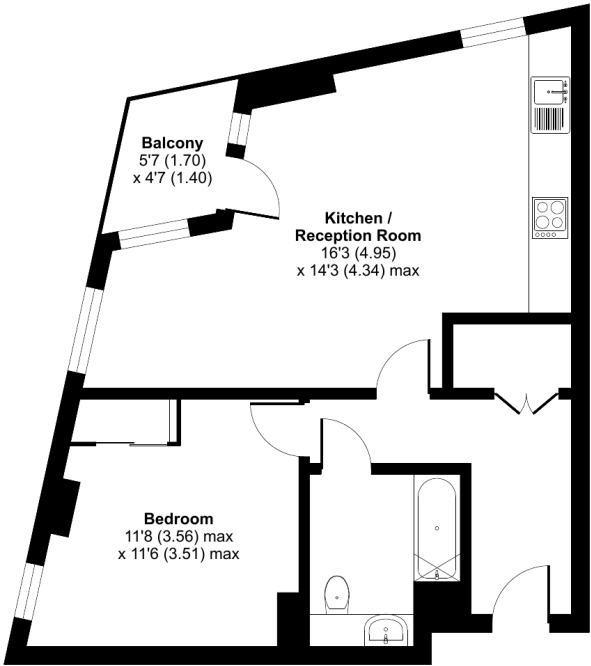

SEVENTH FLOOR



Floor plan produced in accordance with RICS Property Measurement Standards incorporating International Property Measurement Standards (IPMS2 Residential). © rlxhocom 2023. Produced for JLL Residential. REF: 1064181

22 College Approach, Greenwich, London, SE10 9HY

Sales, Lettings & Property Management

Tel: 020 8858 9986

residential.jll.co.uk

