



Granite Apartments, River Gardens Walk, Greenwich, London SE10 0GA



Granite Apartments, Greenwich. SE10

Leasehold

This fantastic luxury two double bedroom property with fantastic views to the river Thames and Canary Wharf.

Key Features

- 2 Double bedrooms
- 2 Bathrooms
- Fantastic river views
- 24 Hour concierge
- Lease: 986 years
- Service Charge: £5,500 p/a
- Ground Rent: £400 p/a
- EPC: B

The property is located a short walk along the river to the Cutty Sark DLR and to the centre of Greenwich for local shops, restaurants and bars.

The accommodation comprises a spacious and light living room with open plan to modern white gloss kitchen with integrated appliances, balcony with river views. Two double bedrooms, master bedroom with large fitted wardrobes and luxurious four piece ensuite bathroom and a second double bedroom and a separate family bathroom.

The property also benefits from a 24 hour concierge service, gym and swimming pool. The property is offered to the market with no onward chain, early viewings are highly recommended.









Granite Apartments, 30 River Gardens Walk, London, SE10

Approximate Area = 969 sq ft / 90 sq m

For identification only - Not to scale

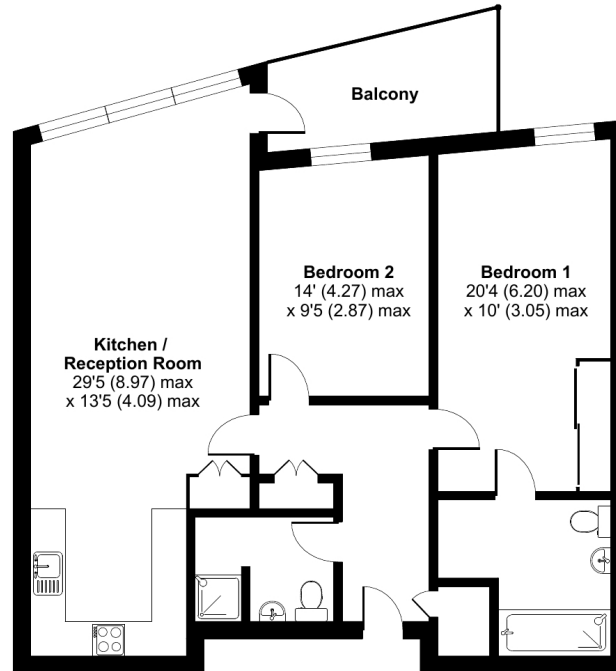

THIRD FLOOR



Floor plan produced in accordance with RICS Property Measurement Standards incorporating International Property Measurement Standards (IPMS2 Residential). © rlxhocom 2024. Produced for JLL Residential. REF: 1070312

22 College Approach, Greenwich, London,
SE10 9HY

Sales, Lettings & Property Management

Tel: 020 8858 9986

residential.jll.co.uk

