



Admirals Tower, 8 Dowells Street, London SE10 9GE



Admirals Tower, New Capital Quay, SE10

Leasehold

This fantastic two double bedroom apartment has sweeping views across the river Thames and depicts many of London's Landmarks.

Key Features

- 2 Double bedrooms
- 2 Bathrooms
- Stunning river views
- Concierge
- 3,5+ Council Tax Band: F
- Ground Rent: £350
- Service Charge: £3,598.50
- EPC: C

The property is located a short walk from the Cutty Sark DLR and Greenwich mainline station allowing easy access to Canary Wharf and the City.

The property comprises of a light spacious open plan living room to modern fitted kitchen, floor ceiling windows with outstanding views. Master bedroom with built in wardrobes and modern fitted ensuite shower room. Second spacious double bedroom with fitted wardrobes. Family bathroom with modern fixtures and fittings with ample storage. Large hallway cupboard and parking included.

The Admirals Tower also benefits from a concierge and Waitrose supermarket on site.

Early viewings are highly recommended,











Admirals Tower, SE10

CAPTURE DATE
09/01/2020

LASER SCAN POINTS
25,618,836

GROSS INTERNAL AREA

75.8 Sqm / 815.6 Sqft

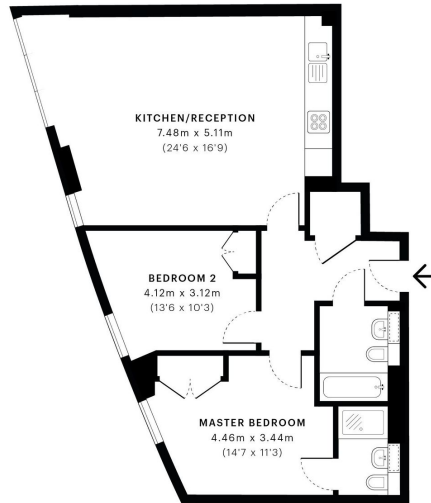

— Tenth Floor



Spec floor plans are produced in accordance with the Royal Institution of Chartered Surveyors' Property Measurement Standards. Plots and gardens are illustrative only and are excluded from all area calculations. Due to rounding, numbers may not add up precisely.



IPMS 2B RESIDENTIAL
76.1 Sqm / 819.3 Sqft

IPMS 3C RESIDENTIAL
73.5 Sqm / 790.7 Sqft

SPEC ID

5e1340121eedbc0c8c2ca012

GROSS AREA (INTERNAL)
The footprint of the property
75.8 Sqm / 815.6 Sqft

NET AREA (INTERNAL)
Excludes walls and external features
73.1 Sqm / 787.0 Sqft

EXTERNAL STRUCTURAL FEATURES
(Balconies, terraces, verandas etc.)
0.0 Sqm / 0.0 Sqft

RESTRICTED HEAD HEIGHT
(Living areas over 1.5m)
0.7 Sqm / 7.7 Sqft

22 College Approach, Greenwich, London,
SE10 9HY

Sales, Lettings & Property Management

Tel: 020 8858 9986

residential.jll.co.uk

