

Kensington Garden Square, London W2
Price £545 per week - Furnished







Description

A lovely fifth floor apartment (with lift) in this Grade II Listed building overlooking Kensington Gardens Square. The property comprises one double bedroom, one bathroom, reception room and a fully fitted, open plan kitchen. The flat has been finished to an excellent standard and further benefits include bespoke kitchen with Miele appliances, American walnut flooring in the reception room, comfort cooling, underfloor heating in the bathroom, 24 hour security and use of the communal gardens. An elegant residence with impeccable character, Garden House occupies a position of undeniable status and prestige in one of London's most exclusive postcodes.

Rent is payable on a monthly basis and you may be required to pay more than a month's rent in advance, depending on your circumstances. You will be required to pay a 1 week holding deposit following a successful offer. Utility bills, council tax, telephone line and broadband are not included in the rent. As well as paying the rent, you may also be required to make some additional permitted payments. If your tenancy does not qualify as an AST, additional fees may apply. Please visit jll.co.uk/fees for details of fees which may be payable when renting a property.

- 1 Double bedroom
- 1 Bathroom
- Reception room
- Open plan kitchen
- 24 Hour security
- Use of communal gardens
- Council tax: D
- Approx. 305 sq ft (28 sq m)
- Furnished
- EPC: C

Floorplan

305 sq ft | 28 sq m

Garden House, Kensington Garden Square, W2

Approximate Gross Internal Area
28.55 sq m / 307 sq ft

(Including restricted height
under 1.5m [-----])

(CH = Ceiling Heights)

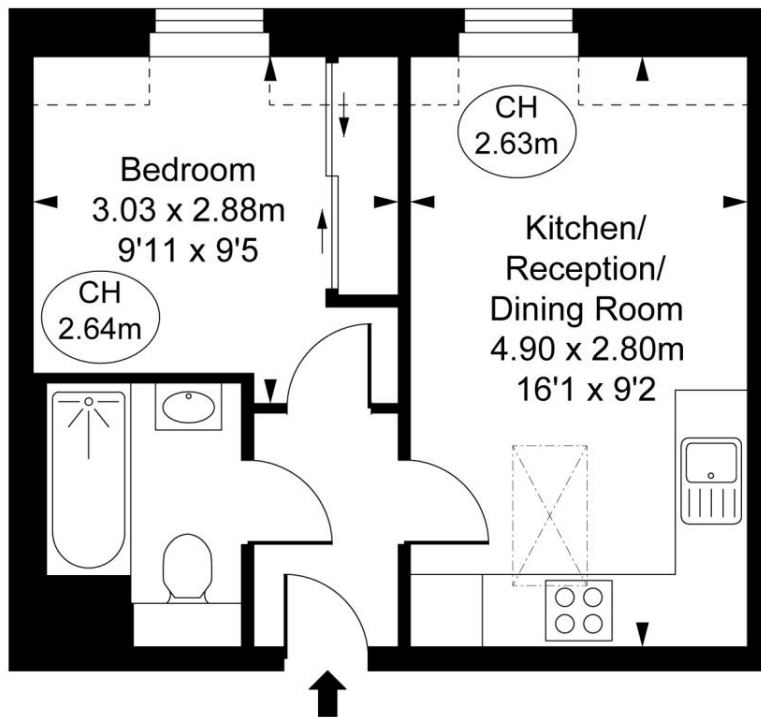

Fifth Floor

This plan is not to scale. It is for guidance and not for valuation purposes.
All measurements and areas are approximate only, and have been prepared in accordance with the current edition of the RICS Code of Measuring Practice.
© Fulham Performance

Chelsea
2 Cale Street,
London SW3 3QU
+4420 7399 5010
lettingschelsea@eu.jll.com

Urban living, your way.

jll.co.uk/residential

© 2019 Jones Lang LaSalle IP, Inc. All rights reserved. All information contained herein is from sources deemed reliable; however, no representation or warranty is made to the accuracy thereof.

