



Norton House, Duke of Wellington Avenue, Woolwich, SE18 6PD



## Norton House, London, SE10

Leasehold (994 years remaining)

**Located on the 15th floor in Royal Arsenal, this light and spacious two bedroom apartment offers beautiful river views and is only a few minutes walk from Woolwich Elizabeth Line station.**

### Key Features

- 2 Double bedrooms
- 2 Bathrooms
- 24-Hour concierge
- Council Tax: D
- Ground Rent: £402 p/a
- Service Charge: £3,600 p/a
- Residents gym & pool
- EPC: B

This modern two bedroom, two bathroom, apartment comprises a large, open plan kitchen / reception room which opens up onto a good sized balcony overlooking the river. The property is painted in neutral tones throughout and includes an entrance hall with two built in storage cupboards. Large windows throughout give the living area a light and spacious feel.

Located near the banks of the River Thames in the Royal Borough of Greenwich, Royal Arsenal Riverside is a thriving new development constructed by Berkeley Homes. The apartment enjoys access to excellent facilities including a 24-Hour concierge, swimming pool, gym, sauna, steam room, vitality pool communal gardens and private residents' cinema.

Also on your doorstep is a selection of shops, cafes bars and restaurants together with excellent transport links via Woolwich Elizabeth Line Station, Woolwich Arsenal DLR and national rail station.









nichecom

DRAFT COPY FOR PROOFING PURPOSES

# Duke Of Wellington Avenue, London, SE18

Approximate Internal Area = 763 sq ft / 70.9 sq m

Balcony = 120 sq ft / 11.1 sq m

For identification only - Not to scale

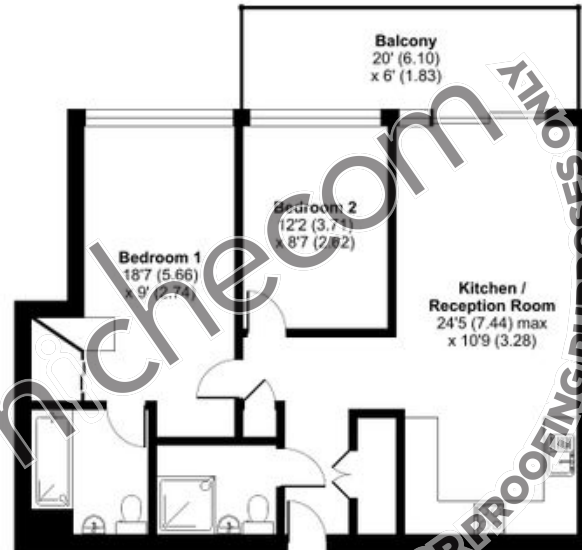

FIFTEEN FLOOR



Floor plan produced in accordance with RICS Property Measurement Standards incorporating International Property Measurement Standards (IPMS2 Residential). © nichecom 2024. Produced for JLL Residential. REF: 1104373

22 College Approach, Greenwich, London, SE10 9HY

Sales, Lettings & Property Management

Tel: 020 8858 9986

[residential.jll.co.uk](http://residential.jll.co.uk)

