



## Station Street, London E15

Asking price £650,000 Leasehold











## Description

Available to the market, spacious and ultra modern 2 bedroom 2 bathroom apartment complete with a private winter garden situated on the 15th floor in the popular Stratford Plaza development, also known as Unex Tower E15.

Situated on the 15th floor and comprising approximately 1064 square feet, the property boasts an open-plan kitchen/living area with integrated appliances, winter garden, floor-to-ceiling windows allowing plenty of light, double bedrooms and two bathrooms (including an en suite).

All transport facilities on your doorstep, with Stratford station being one minute's walk away. Just moments from the Centre of London and perfectly positioned for fast and easy access to Canary Wharf and The City.

Europe's largest retail and leisure destination is literally next door, with over 300 stores offering designer fashion, restaurants and bars, a casino and a state of the art digital cinema. The Olympic legacy provides world class sporting facilities with many of the arenas open to the public.

Residents further benefit from a concierge service, lift access, secured bicycle storage, roof terrace and close to local amenities.

- 2 Bedrooms
- 2 Bathrooms
- 15th floor
- 24hr Concierge service
- Residential roof terrace
- Winter garden
- Secure bicycle storage
- Lift access
- Views towards Canary Wharf, the River Thames & the O2
- 0.1 mile to Stratford Underground Station

# Floorplan

930 sq ft | 86 sq m

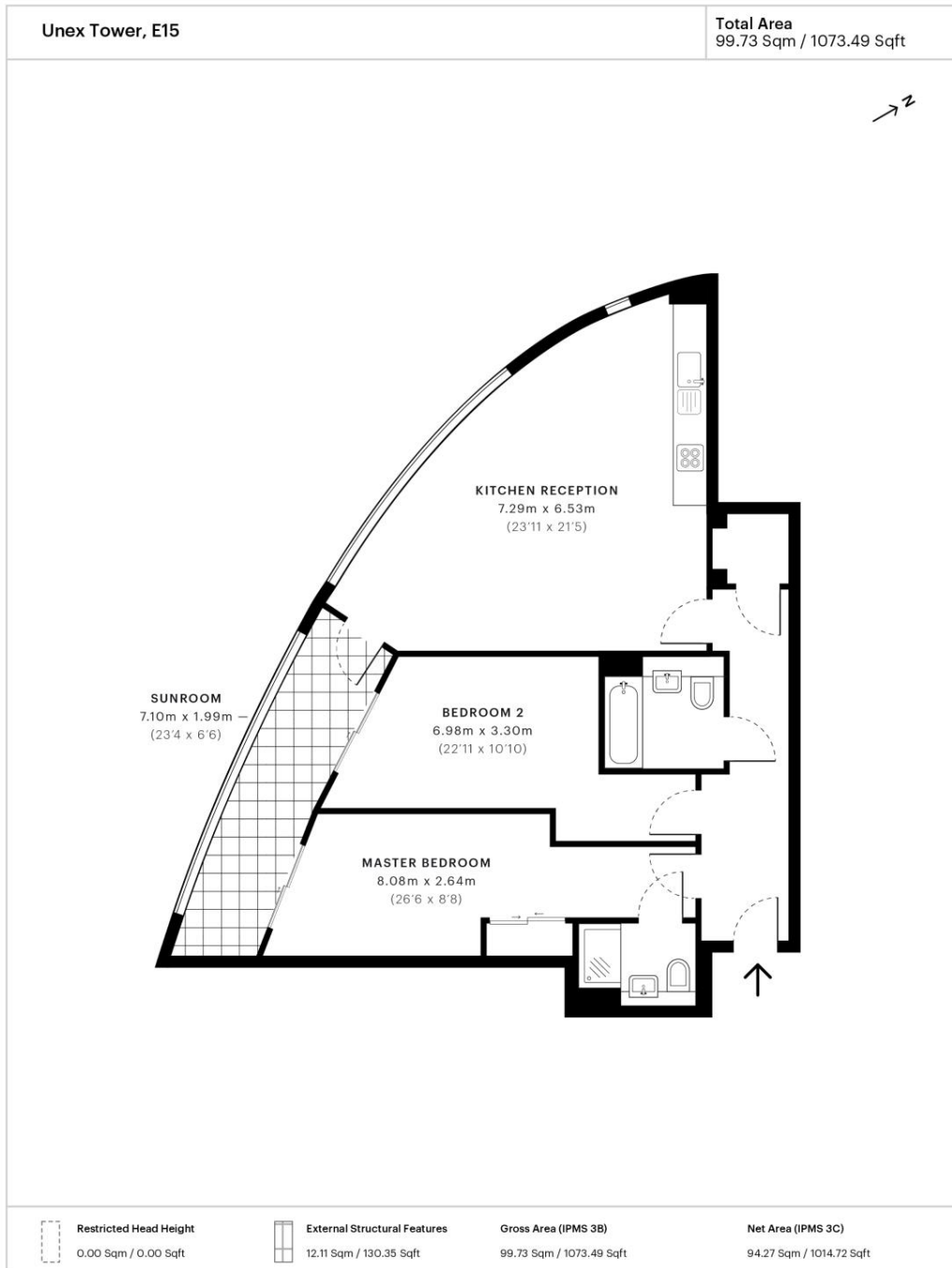

Spec floor plan captured for JLL, Stratford on 25/07/2018 using **128,543,736** laser scan points, accurate to +/- 3cm. Produced in accordance with Royal Institution of Chartered Surveyors Property Measurement Standards, incorporating International Property Measurement Standard (IPMS). If you intend to rely on any measurement in a transaction you should perform your own checks. Plot/Gardens illustrative only and excluded from all area calculations. SpectID: 5b51a2a882f4e30c5fe4b3a1

**Restricted Head Height** = Limited use area under 1.5m. **External Structural Features** = Balconies, terraces or verandas or similar. **IPMS 3B** = gross internal area measured from the internal faces of external walls, including walls/obstructions and External Structural Features, excluding stairwell area above/below the ground floor. **IPMS 3C** = net area of IPMS 3B excluding internal walls/obstructions and stairwell area above/below the ground floor. **Total Internal Area** = IPMS 3B gross area + stairwell area above/below ground floor of 0.00 Sqm / 0.00 Sqft.



Stratford  
5 Station Street,  
London E15 1DA  
+4420 3147 1500  
salesstratford@eu.jll.com

*Urban living, your way.*

[jll.co.uk/residential](http://jll.co.uk/residential)

© 2019 Jones Lang LaSalle IP, Inc. All rights reserved. All information contained herein is from sources deemed reliable; however, no representation or warranty is made to the accuracy thereof.

