



## Townmead Road, London SW6

Price £475 per week - Furnished





# Description

This property is located in the popular Imperial Wharf, London SW6 development for rent. The Manhattan style apartment is a lovely studio with a brand-new bathroom and modern kitchen. Added benefits include 24-hour concierge and an exclusive health and fitness suite. Good transport connections bring Octavia House within easy reach of the fashionable areas of Chelsea and King's Road.

Rent is payable on a monthly basis and you may be required to pay more than a month's rent in advance, depending on your circumstances. You will be required to pay a 1 week holding deposit following a successful offer. Utility bills, council tax, telephone line and broadband are not included in the rent. As well as paying the rent, you may also be required to make some additional permitted payments. If your tenancy does not qualify as an AST, additional fees may apply. Please visit [jll.co.uk/fees](http://jll.co.uk/fees) for details of fees which may be payable when renting a property.

- Studio
- Modern kitchen
- Brand new bathroom
- Furnished
- 24 hour concierge
- Health and fitness suite
- Second floor
- Approx. 296 sq ft (27.48 sq m)
- EPC: B
- Council tax: Band D



# Floorplan

296 sq ft | 28 sq m

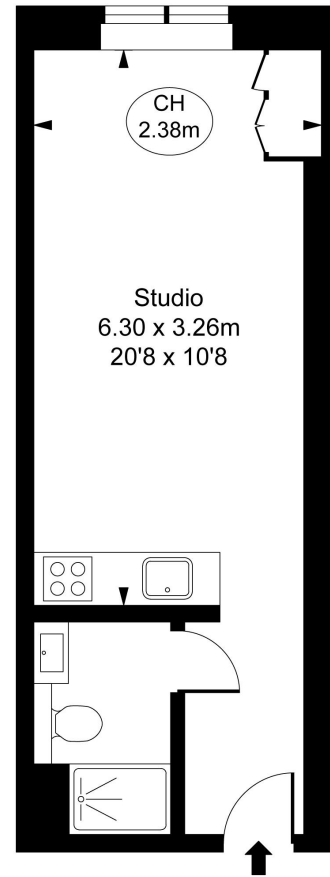

Octavia House,  
Townmead Road, SW6  
Approximate Gross Internal Area  
27.48 sq m / 296 sq ft  
( CH = Ceiling Heights )



## Second Floor

This plan is not to scale. It is for guidance and not for valuation purposes.  
All measurements and areas are approximate only, and have been prepared in accordance with the current edition of the RICS Code of Measuring Practice.  
© Fulham Performance

Chelsea  
2 Cale Street,  
London SW3 3QU  
+4420 7399 5010  
lettingschelsea@eu.jll.com

*Urban living, your way.*

[jll.co.uk/residential](http://jll.co.uk/residential)

© 2019 Jones Lang LaSalle IP, Inc. All rights reserved. All information contained herein is from sources deemed reliable; however, no representation or warranty is made to the accuracy thereof.

