



**High Street, London E15**  
Asking price £485,000 Leasehold









## Description

This contemporary 10th-floor apartment boasts two bedrooms, two bathrooms, and breathtaking panoramic views. Situated in the renowned City West Tower development on Stratford High Street, E15.

This expansive apartment features a fully equipped, high-spec kitchen, lavishly tiled bathrooms with mirrored cabinets, two generous double bedrooms with ample storage and a spacious reception room boasting floor-to-ceiling windows that offer stunning, far-reaching views towards Canary Wharf (Southwest).

City West Tower is conveniently located within walking distance of the Olympic Park, and is also a short stroll away from Pudding Mill Lane DLR station and Bow DLR, providing easy access to Westfield shopping centre and Stratford underground station, connecting to multiple tube lines and overground transportation options.

Years remaining on lease: 992, Service charge: TBC, Ground rent: £450pa, Council tax band: D

- Two bedrooms
- Two bathrooms (one en-suite)
- 10th Floor
- Approx. 799 sq. ft (74.2 sq.m)
- Residents' gym
- Concierge service
- Built in 2016
- EPC Rating B

# Floorplan

799 sq ft | 74 sq m

## CITY WEST TOWER

APPROXIMATE GROSS INTERNAL FLOOR AREA 799 SQ.FT (74.2 SQ.M)

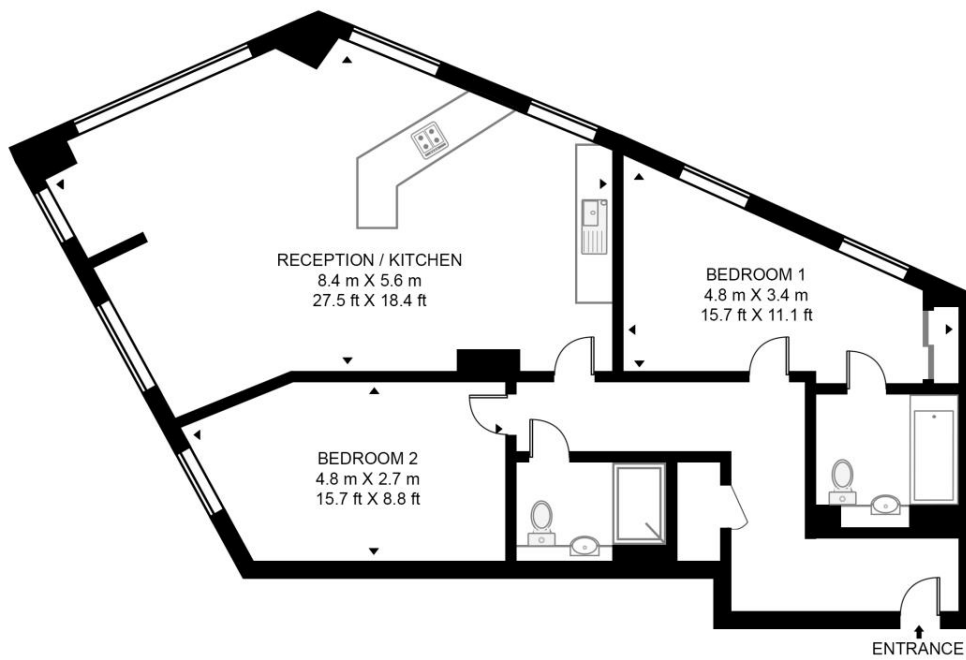

## TENTH FLOOR



This floor plan has been defined by the RICS Code of Measurement. This floor plan and all others are for approximate representative purposes only and upon usage is agreed to as such by the client.  
WWW: [hdvirtualart.com](http://hdvirtualart.com) | TEL: 0203.974.1567 | EMAIL: [info@hdvirtualart.com](mailto:info@hdvirtualart.com)

Stratford  
5 Station Street,  
London E15 1DA  
+4420 3147 1500  
[Lettingsstratford@eu.jll.com](mailto:Lettingsstratford@eu.jll.com)

*Urban living, your way.*

[jll.co.uk/residential](http://jll.co.uk/residential)

© 2019 Jones Lang LaSalle IP, Inc. All rights reserved. All information contained herein is from sources deemed reliable; however, no representation or warranty is made to the accuracy thereof.

