



**Kensington Garden Square, London W2**  
Asking price £575,000 Leasehold







## Description

A lovely fifth floor apartment (with lift) in this Grade II Listed building overlooking Kensington Gardens Square. The property comprises one double bedroom, one bathroom, reception room and a fully fitted, open plan kitchen. The flat has been finished to an excellent standard and further benefits include bespoke kitchen with Miele appliances, American walnut flooring in the reception room, comfort cooling, underfloor heating in the bathroom, 24 hour security and use of the communal gardens. An elegant residence with impeccable character, Garden House occupies a position of undeniable status and prestige in one of London's most exclusive postcodes.

- 1 Double bedroom
- 1 Bathroom
- Open-plan kitchen/reception
- 24 Hour security
- Communal gardens
- Approx 305 sq ft / 28 sq m
- EPC: C

# Floorplan

305 sq ft | 28 sq m

## Garden House, Kensington Garden Square, W2

Approximate Gross Internal Area  
28.55 sq m / 307 sq ft

( Including restricted height  
under 1.5m [-----] )

( CH = Ceiling Heights )

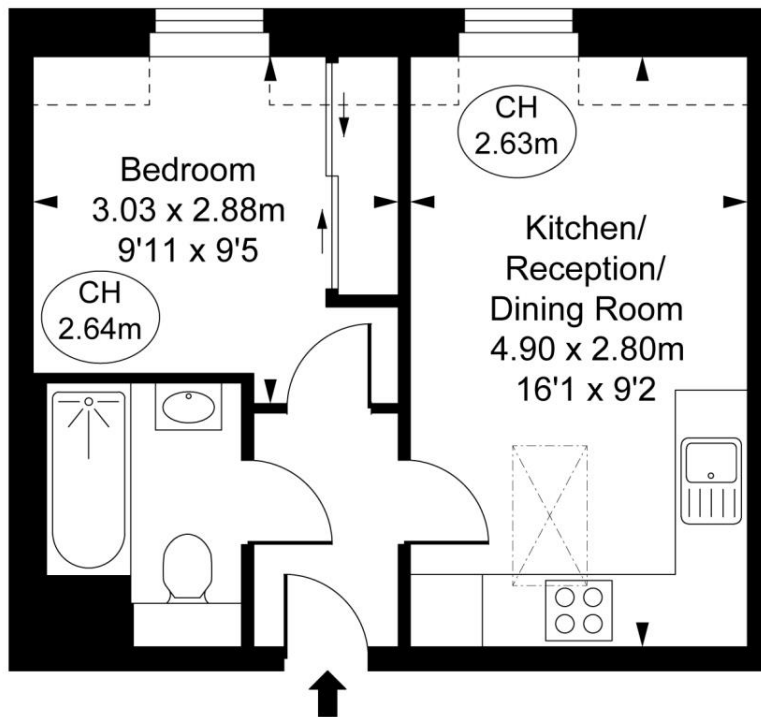

Fifth Floor

This plan is not to scale. It is for guidance and not for valuation purposes.  
All measurements and areas are approximate only, and have been prepared in accordance with the current edition of the RICS Code of Measuring Practice.  
© Fulham Performance

Kensington  
387 Kensington High Street,  
London W14 8QA  
+4420 7087 5696  
lettingskensington@eu.jll.com

*Urban living, your way.*

[jll.co.uk/residential](http://jll.co.uk/residential)

© 2019 Jones Lang LaSalle IP, Inc. All rights reserved. All information contained herein is from sources deemed reliable; however, no representation or warranty is made to the accuracy thereof.

