



Grand Central Apartments, London NW1

Price £4,100 per month - Furnished





Description

The apartment is finished to a high standard and comprises an open plan living space, with a stylish and fully integrated kitchen, living area with floor to ceiling windows, a spacious principal bedroom with fitted wardrobes and a modern en-suite bathroom, a second double bedroom and a family bathroom suite with bath and overhead rainfall shower. Each apartment has a private balcony, and the apartment is offered furnished.

Grand Central Apartments, a new residential tower just a short walk to Kings Cross with secure entry, concierge service, lift access and bicycle storage.

Rent is payable on a monthly basis, and you may be required to pay more than a month's rent in advance, depending on your circumstances. You will be required to pay a 1 week holding deposit following a successful offer. Utility bills, council tax, telephone line and broadband are not included in the rent. As well as paying the rent, you may also be required to make some additional permitted payments. If your tenancy does not qualify as an AST, additional fees may apply. Please visit jll.co.uk/fees for details of fees which may be payable when renting a property.

- Modern Development
- 14th Floor
- Private Balcony
- Concierge Service
- Open-Plan Living
- Wooden Flooring
- Furnished
- Floor to Ceiling Windows
- Close to Kings Cross / St. Pancras Stations
- Council tax: Band F



Grand Central Apartments, NW1

Approximate Gross Internal Area
71.61 sq m / 771 sq ft

(CH = Ceiling Heights)

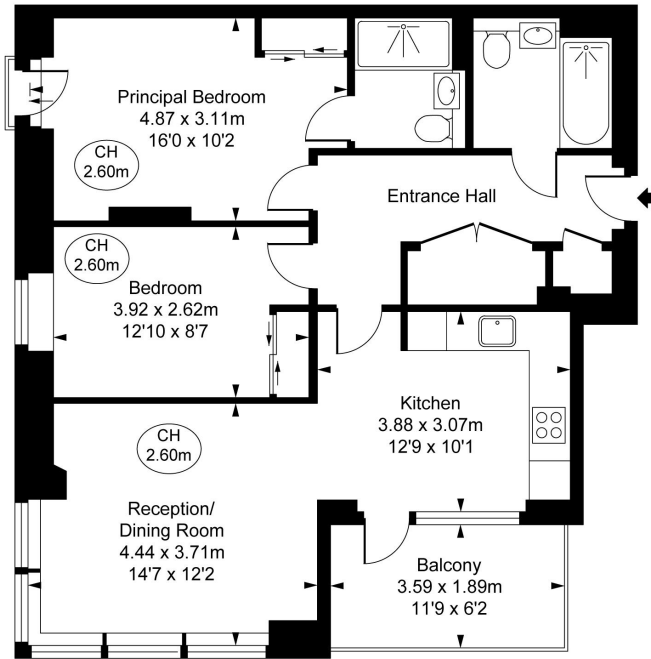

Fourteenth Floor

This plan is not to scale. It is for guidance and not for valuation purposes.
All measurements and areas are approximate only, and have been prepared in accordance with the current edition of the RICS Code of Measuring Practice.
© Fulham Performance