



Chesson Road, London W14

Asking price £1,425,000 Freehold







Description

Nestled in a quiet residential road, this inviting 3 bedroom mid-terrace house on Chesson Road 130 yards from Normand Park's lush greenery, outdoor gym and playground, and within half a mile to West Kensington station this location provides an ideal balance of urban convenience and peaceful living. This charming property unfolds across multiple levels, each floor revealing thoughtfully designed spaces that cater to modern living while retaining classic appeal.

The lower ground floor welcomes you with an elegant living room that flows seamlessly into a comfortable dining area, then a semi-separate kitchen, with its direct access to the rear garden.

Ascending to the ground floor, you'll find a generous double reception room, spanning an impressive 27'8" x 16', perfect for entertaining or family gatherings. A small study tucked away on this level offering a quiet workspace.

The first floor houses 2 spacious double bedrooms with integrated storage and a well-appointed family bathroom. Crowning the home is the top floor master suite, a luxurious retreat measuring 19'1" x 15'11", complete with its own en-suite bathroom for ultimate privacy and comfort.

This thoughtfully designed home seamlessly blends period charm with modern living, offering a versatile and inviting space for those seeking a peaceful urban oasis.

- 3 Double bedrooms
- 3 Bathrooms plus guest WC
- Living room, semi-separate kitchen, dining room and double reception
- Private garden
- Residential permit parking
- Normand Park 130 yards
- West Kensington station 0.5 miles
- West Brompton station 0.6 miles
- EPC C

Floorplan

1,932 sq ft | 180 sq m

Chesson Road, W14

Approximate Internal Area = 1897 sq ft / 176.2 sq m (excludes shed / boiler)

Limited Use Area(s) = 35 sq ft / 3.2 sq m

Total = 1932 sq ft / 179.4 sq m

For identification only - Not to scale



Denotes restricted head height

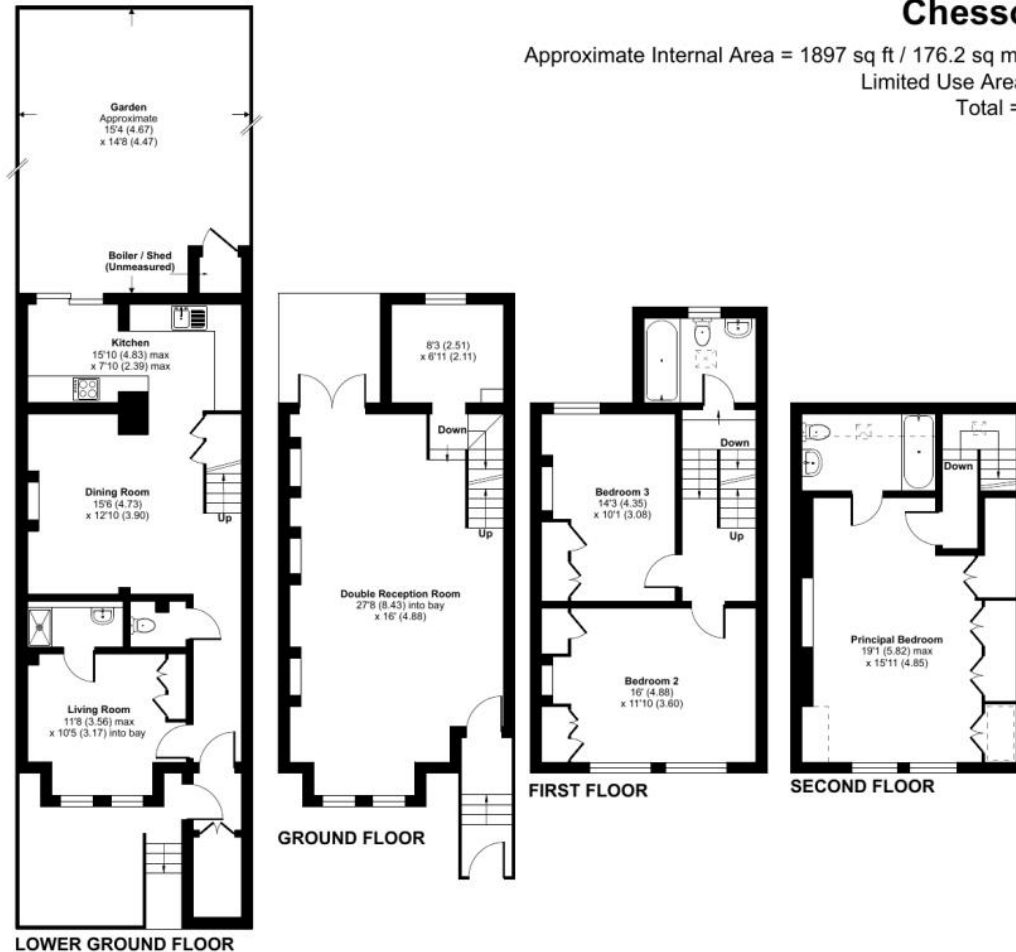

Floor plan produced in accordance with RICS Property Measurement Standards incorporating International Property Measurement Standards (IPMS2 Residential). © ncthecom 2024. Produced for JLL Residential. REF: 1194018

Kensington
387 Kensington High Street,
London W14 8QA
+4420 7087 5696
lettingskensington@eu.jll.com

Urban living, your way.

jll.co.uk/residential

© 2019 Jones Lang LaSalle IP, Inc. All rights reserved. All information contained herein is from sources deemed reliable; however, no representation or warranty is made to the accuracy thereof.

