



Grayston House, 21 Astell Road, Blackheath, London, SE3



Grayston House, Blackheath, London, SE3

Leasehold (986 years remaining)

A superb apartment in Grayston House in the ever popular Kidbrooke Village development. 24- hour concierge, local amenities and excellent transport links are within a short walk away.

Key Features

- 1 Bedroom
- Private balcony
- Beautifully presented throughout
- Close to Kidbrooke Village mainline
- Council Tax: C
- Service Charge: **£2,800 P/A**
- Ground Rent: **£325 P/A**
- EPC: B

The property is finished to a high standard and comprises good sized entrance hall with built in cupboard/utility and doors leading to all rooms. Open-plan living room / dining and kitchen area with floor to ceiling windows and access onto a property balcony overlooking the grounds. A good sized double bedroom with built in wardrobes and a separate family bathroom to finish off the property.

Kidbrooke Village as a whole is known for its emphasis on creating a sustainable community with a mix of housing types, green spaces, and local facilities. The development includes parks, shops, schools, and transport links offering regular trains from the on-site Kidbrooke Station to London Bridge (16 mins), Waterloo East (19 mins), Charing Cross (25 mins) and Victoria Stations (28 mins). Trains also connect to Lewisham, providing DLR to Greenwich, Canary Wharf, Stratford and London City Airport.









Grayston House

Approximate Gross Internal Area = 50.0 sq m / 538 sq ft

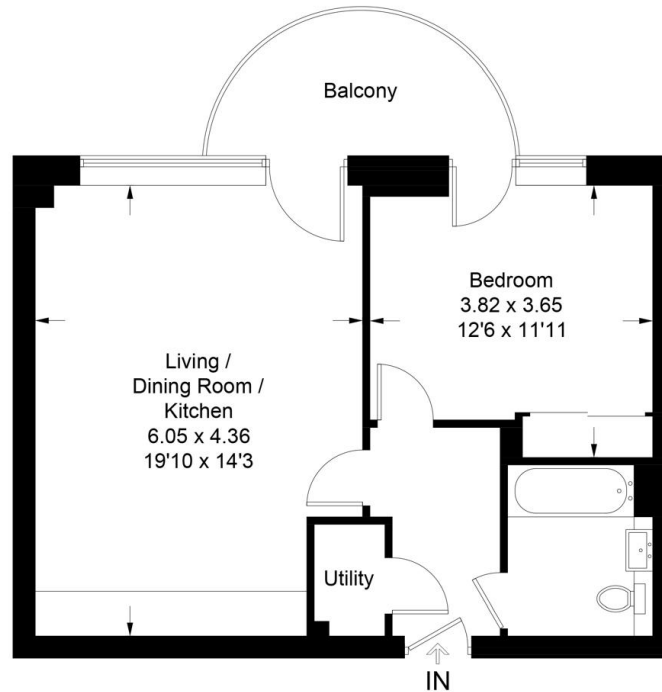

Illustration for identification purposes only, measurements are approximate, not to scale. Fourlabs.co © (ID1134087)

22 College Approach, Greenwich,
London, SE10 9HY
Tel: 020 7399 5595

Sales, Lettings & Property Management

residential.jll.co.uk

