

CRANMER COURT

WHITEHEADS GROVE SW3

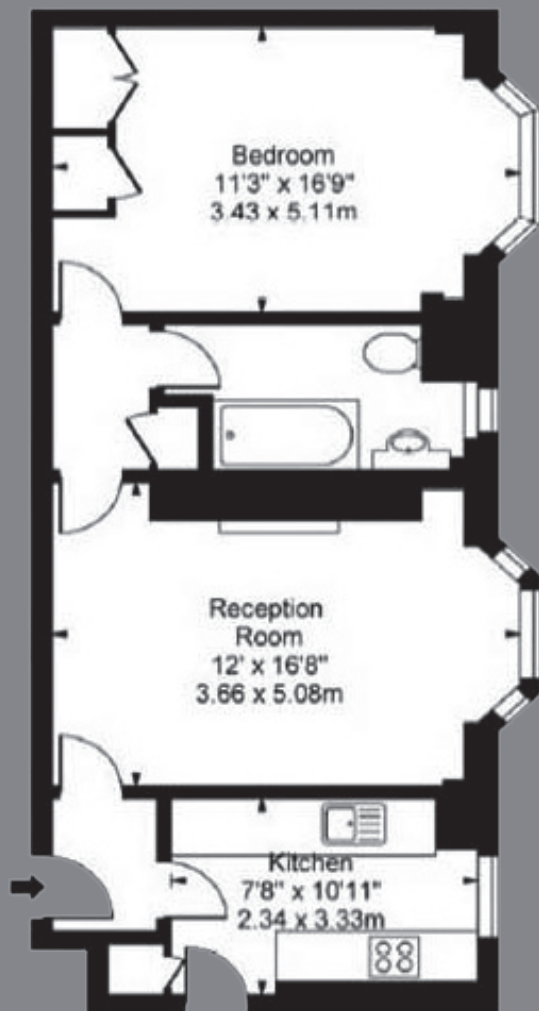

GROSS INTERNAL AREA (APPROX.)
54.25 Sq m (584 Sq ft)



Sixth Floor

**A VERY COMFORTABLE
ONE BED FLAT SITUATED
ON THE SIXTH FLOOR
OF THIS VERY WELL
REGARDED BLOCK WITH
24/7 SECURITY AND
PORTERAGE.**

Cranmer Court is located halfway
up Sloane Avenue in the heart of
Chelsea and equidistant from Sloane
Square and South Kensington.

FACILITIES

1 Double bedroom | 1 Bathroom
Reception room | Fully fitted kitchen
24-hour porter | Lift

TERMS

Price - £850,000
Lease length - 116 years (expires 1st
of April 2141)
Service charge - £7,188 per annum
Ground rent - Peppercorn
Local authority - Kensington &
Chelsea
Council tax - F
EPC - D



These particulars are for general information only and do not constitute any part of an offer or contract. All statements contained therein are made without responsibility on the part of the vendors or lessors and are not to be relied upon as statement or representation of fact. Intending purchasers or lessees must satisfy themselves, by inspection, or otherwise, as to the correctness of each of the statements or dimensions contained in these particulars.

JLL Chelsea & Knightsbridge
2 Cale Street
London, SW3 3QU

020 7306 1610

