



Baquba Building, Lewisham, London SE13 7FF



B111 Baquba Building, Lewisham, SE13

Leasehold (897 years remaining)

A fabulous apartment on the first floor of this popular modern development conveniently located just 100 meters from Elverson Road DLR, local shops and Lewisham town centre.

Key Features

- 1 Bedroom
 - Balcony
 - 24 hour concierge and gym
 - Council Tax: **B**
 - Service Charge: **£2,100 P/A**
 - Ground Rent: **£350 P/A**
 - Close to transport links
 - EPC: **B**
-

A fabulous one bedroom apartment on the 1st floor of this popular modern development conveniently located just 100 meters from Elverson Road DLR, local shops and Lewisham town centre.

The property is light and bright throughout with a great standard of finish and briefly comprises one double bedroom with built in wardrobes, a modern family bathroom and an open plan kitchen with a range of integrated appliances that leads to a spacious lounge with patio doors opening out onto the balcony.

Further benefits are a helpful 24 hour concierge, a residents gym and no onward chain.









Baquba

Approximate Gross Internal Area = 38.1 sq m / 411 sq ft

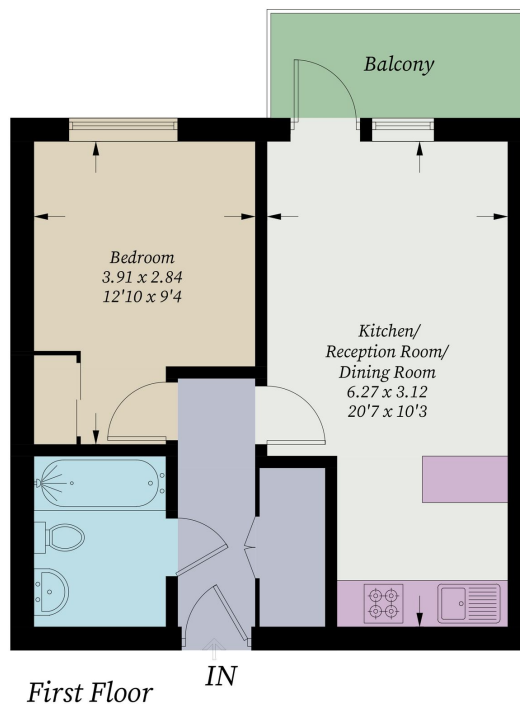

First Floor

IN

Illustration for identification purposes only, measurements are approximate,
not to scale. Fourlabs.co © (ID1193863)

22 College Approach, Greenwich,
London, SE10 9HY
Tel: 020 7399 5595

Sales, Lettings & Property Management

residential.jll.co.uk

