



Tunnel Avenue, Greenwich, SE10 0SD



## Tunnel Avenue, Greenwich, London, SE10

### Freehold

A well-presented, end of terrace family home located in this popular street in East Greenwich with street parking and easy access to Greenwich town centre.

### Key Features

- 2 Double bedrooms
- Front and Rear gardens
- On-street parking
- In-need of cosmetic updating
- Council Tax: **C**
- Walk to mainline stations
- Local amenities
- EPC: **D**

The accommodation comprises entrance hall with access into living / dining room with a feature fireplace and access onto a rear garden with is laid to lawn and a separate fitted kitchen. The first floor offers two double bedrooms and a family bathroom.

The property is well located for access to Westcombe Park main line station and North Greenwich Jubilee Line extension, and central Greenwich is a short drive away offering an excellent selection of shops, bars and restaurants.

The property is being marketed with no onward chain, early viewings are highly recommended









## *Tunnel Avenue, SE10*

Approximate Gross Internal Area = 66.0 sq m / 710 sq ft

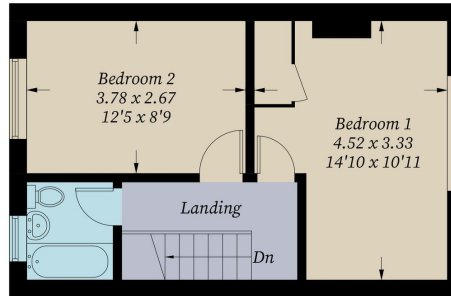

*First Floor*

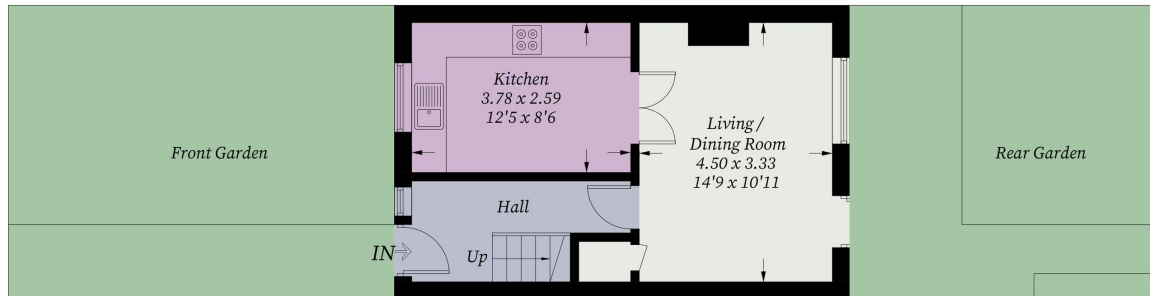

*Ground Floor*

Illustration for identification purposes only, measurements are approximate, not to scale. Fourlabs.co © (ID1185172)

22 College Approach, Greenwich,  
London, SE10 9HY  
Tel: 020 7399 5595

**Sales, Lettings & Property Management**

**residential.jll.co.uk**

