



Etherington Lodge, 5 Trathen Square, Greenwich SE10 0ZJ



Etherington Lodge, Greenwich SE10

Leasehold (993 years remaining)

A light and beautifully presented apartment on the 3rd floor of this modern development which benefits from concierge services and close to transport links and local amenities.

Key Features

- 2 Double bedrooms, 1 Bathroom
- Private balcony
- EWS1 Compliant
- Council Tax: **D**
- Service Charge: **£2,800 P/A**
- Ground Rent: **£400 P/A**
- Close to transport links
- EPC: **B**

The accommodation comprises large entrance hall with built in double cupboards and doors to all rooms. Open-plan kitchen / reception room that opens onto a private balcony with a westerly aspect and far reaching views. The modern kitchen is well-equipped with essential built in appliances.

Two double bedrooms, bedroom one has the extreme benefit of built in wardrobes and a separate family bathroom finishes off the property.

Conveniently located near amenities, shops, and public transportation, this modern flat offers a lifestyle of convenience and accessibility. Whether you're looking to explore the vibrant city or simply enjoy the local neighbourhood, everything you need is just a stone's throw away.

Early viewings are highly recommended.









Etherington Lodge, SE10

Approximate Gross Internal Area = 71.7 sq m / 772 sq ft

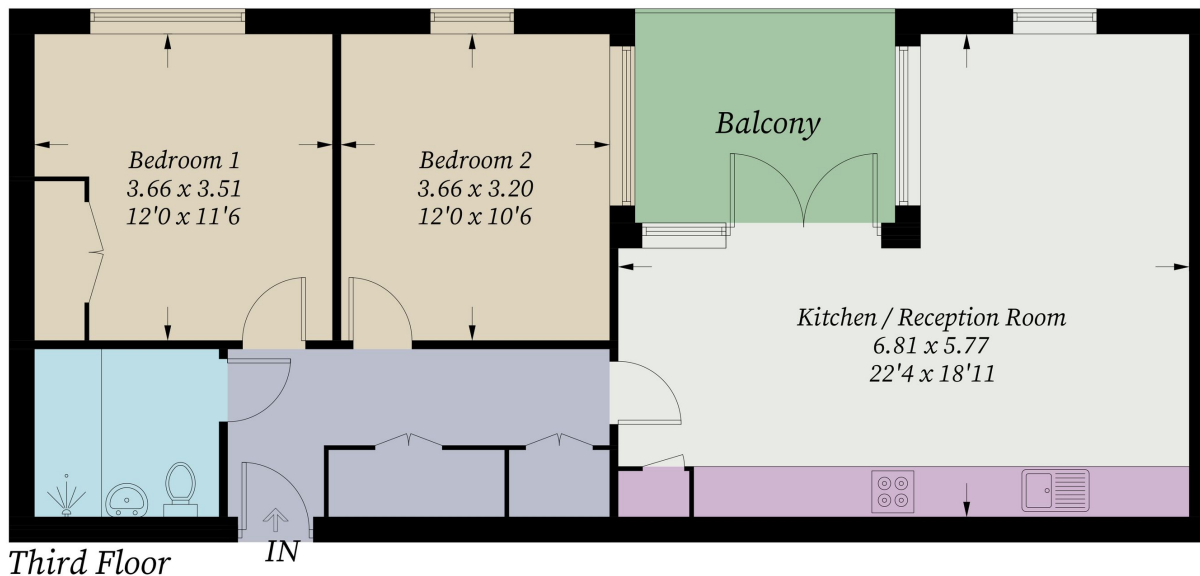

Illustration for identification purposes only, measurements are approximate, not to scale. Fourlabs.co © (ID1210989)

22 College Approach, Greenwich,
London, SE10 9HY
Tel: 020 7399 5595

Sales, Lettings & Property Management

residential.jll.co.uk

