

# Hans Place,

Knightsbridge SW1X 0EP





A perfect pied-a-terre located on the fourth floor of a handsome red bricked building at the south end of this prestigious garden square. Hans Place lies in the heart of Knightsbridge, near to Harrods and just to the west of Sloane Street.

#### Accommodation:

- Bedroom
- Shower room
- Kitchen
- Reception room
- Lift
- Independent gas central heating and hot water

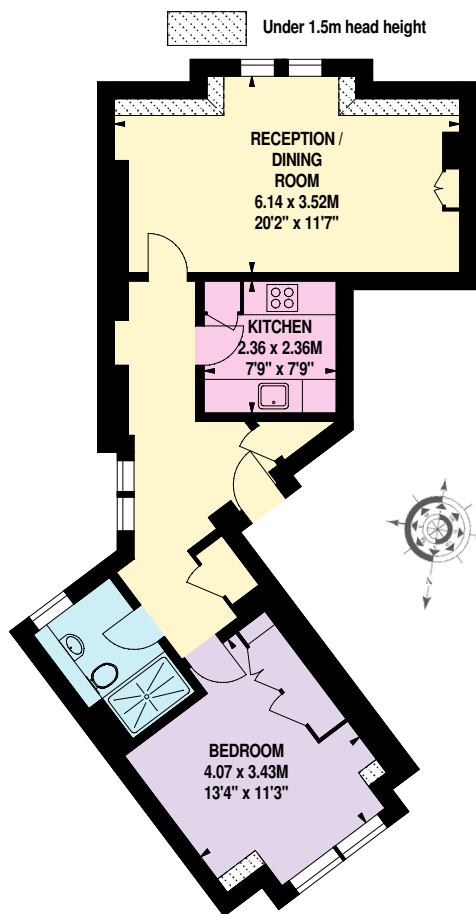

**Fourth Floor**

**GROSS INTERNAL AREA  
56 SQ METRES - 603 SQ FEET**

Guide Price: £775,000

Tenure: Leasehold 124 years

Ground Rent: Peppercorn

Service Charge: £8,169.50 for the year ending 31/3/2026 (including reserve fund contribution)

Local Authority: The Royal Borough of Kensington and Chelsea

Council tax band: G

EPC rating: C



These particulars are for general information only and do not constitute any part of an offer or contract. All statements contained therein are made without responsibility on the part of the vendors or lessors and are not to be relied upon as statement or representation of fact. Intending purchasers or lessees must satisfy themselves, by inspection, or otherwise, as to the correctness of each of the statements or dimensions contained in these particulars.



**JLL Knightsbridge**  
knightsbridge@eu.jll.com | 020 7306 1600  
**JLL Chelsea**  
chelsea@eu.jll.com | 020 7399 5010  
jll.co.uk/residential

**Savills Knightsbridge**  
knightsbridge\_sales@savills.com  
020 7581 5234  
**Savills Sloane Street**  
sloanestreet@savills.com  
020 7730 0822  
savills.co.uk

