



Tinderbox House, 2 Octavius Street, London, SE8 4BY



Tinderbox House, Deptford, SE8

Leasehold (240 years remaining)

Contemporary sixth floor apartment with private balcony overlooking landscaped grounds in modern Deptford development. Excellent transport connections to Canary Wharf and the City, moments from Greenwich's historic attractions.

Key Features

- 1 Bedroom, 1 Bathroom
 - Large Balcony
 - Short walk to Deptford mainline
 - Council Tax: **C**
 - Service Charge: **£3,365 P/A**
 - Ground Rent: **£508.44 P/A**
 - No onward chain
 - EPC: **B**
-

The apartment benefits from abundant natural light and enjoys elevated views over the development's landscaped grounds through its private balcony - perfect for morning coffee or evening relaxation while taking in the peaceful outlook. The thoughtfully designed interior maximises the 571 square feet of living space, creating a comfortable and practical home for contemporary living.

Deptford's transformation has created one of South East London's most dynamic neighbourhoods, where creative energy mingles with maritime history. The area retains its authentic character while embracing new developments, independent cafes, and artistic venues that give the locale its distinctive edge.

Transport connections are exceptional, with New Cross and New Cross Gate stations providing direct services to London Bridge, Canary Wharf, and the City. Deptford Bridge DLR station offers seamless connections to Greenwich and Canary Wharf, while multiple bus routes serve the wider London network. This connectivity makes the property ideal for professionals working across London's business districts.









Tinderbox House

Approximate Gross Internal Area = 53.0 sq m / 571 sq ft

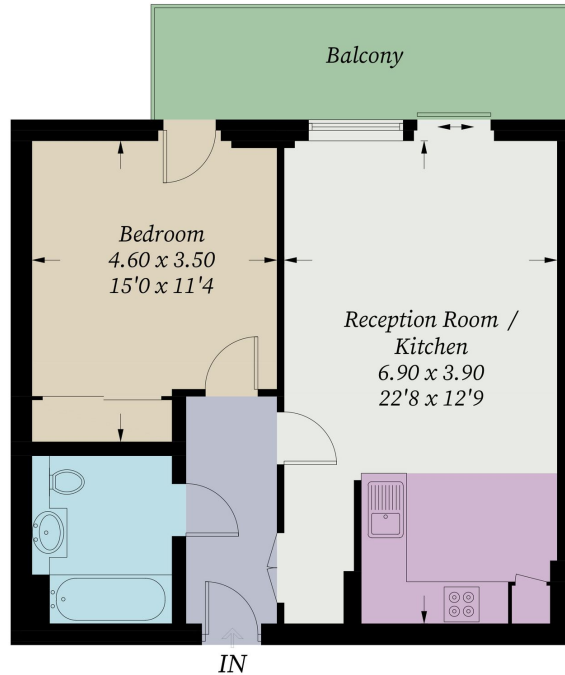

Illustration for identification purposes only, measurements are approximate, not to scale. Fourlabs.co © (ID1248919)

22 College Approach, Greenwich,
London, SE10 9HY
Tel: 020 7399 5595

Sales, Lettings & Property Management

residential.jll.co.uk

