



Gladstone House, Dowells Street, Greenwich, SE10 9FD



Gladstone House, Dowells Street, SE10

Leasehold (111 years remaining)

Sophisticated two-bedroom apartment in prestigious Greenwich development featuring full-length balcony with partial Thames views, allocated parking, and concierge services. Perfect blend of riverside living and historic charm.

Key Features

- Full Length Private Balcony
 - Views over the River Thames
 - Secure Allocated Parking Space
 - On-Site Concierge Services
 - Service Charge: **£2,951.52**
 - Ground Rent: **£250**
 - Excellent Transport Links
 - EPC: **B**
-

Nestled in the heart of historic Greenwich, this stunning two-bedroom apartment situated within the prestigious New Capital Quay development offers an exceptional opportunity for first-time buyers and downsizers seeking contemporary riverside living. The building's modern architecture harmoniously complements Greenwich's rich maritime heritage, creating a distinctive residential environment that captures both elegance and convenience.

This well-presented apartment benefits from an elevated position, ensuring abundant natural light floods through the generous living spaces while offering partial Thames views from the impressive full-length balcony. The outdoor space provides the perfect setting for evening entertaining with friends, extending the living area and creating a seamless indoor-outdoor lifestyle that's rare to find in central London developments.









Gladstone House

Approximate Gross Internal Area = 57.4 sq m / 618 sq ft

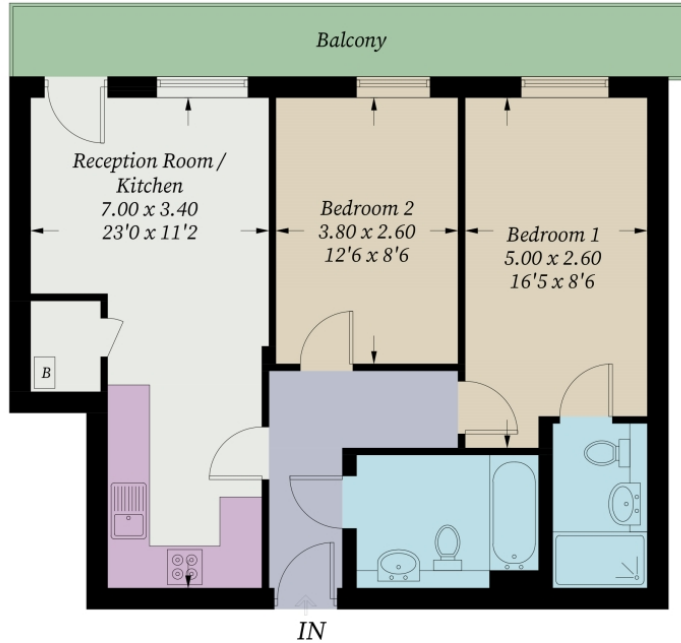

Seventh Floor

Illustration for identification purposes only, measurements are approximate, not to scale. Fourlabs.co © (ID1249146)

22 College Approach, Greenwich,
London, SE10 9HY
Tel: 020 7399 5595

Sales, Lettings & Property Management

residential.jll.co.uk

