



Channelsea Road, London E15

Guide Price £400,000 Leasehold







Description

Situated within the desirable Hallings Wharf Studios development in Stratford, this exceptionally well-maintained two-bedroom apartment exemplifies contemporary urban living at its finest. The development's professional daytime concierge service and secure entrance system provide residents with both convenience and peace of mind in this thriving East London location.

The thoughtfully designed interior showcases impeccable taste throughout, beginning with a welcoming entrance hall that features a practical double storage cupboard. The accommodation flows seamlessly through two generously proportioned double bedrooms, with the master bedroom enjoying the added luxury of a private balcony - perfect for morning coffee or evening relaxation. A fully fitted family bathroom suite completes the sleeping quarters with modern fixtures and fittings.

The heart of the home lies in the beautifully appointed living spaces, where a fully integrated kitchen seamlessly connects to a separate dining area, creating an ideal environment for both everyday living and entertaining.

- Two Bedroom apartment
- Balcony
- Spacious living area
- Finished to a high standard
- 4th Floor
- Daytime concierge
- Short walk to Stratford Underground Station
- Approx. 830 sq. ft (77.1 sq. m)
- EPC Rating B

Floorplan

830 sq ft | 77 sq m

HALLINGS WHARF STUDIOS, CHANNELSEA ROAD APPROXIMATE GROSS INTERNAL FLOOR AREA 830 SQ.FT (77.1 SQ.M)

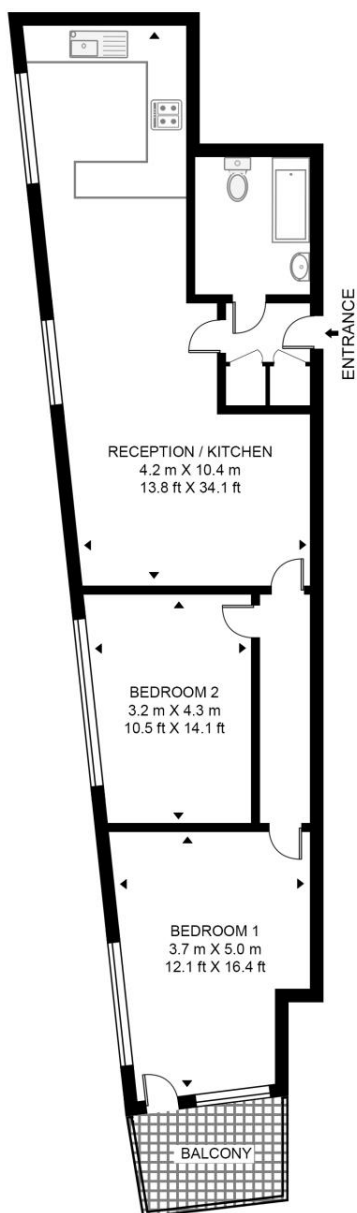

FOURTH FLOOR



This floor plan has been defined by the RICS Code of Measurement. This floor plan and all others are for approximate representative purposes only and upon usage is agreed to as such by the client.
WWW: hdvirtualart.com | TEL: 0203.974.1567 | EMAIL: info@hdvirtualart.com

Stratford
5 Station Street,
London E15 1DA
+4420 3147 1500
Lettingsstratford@eu.jll.com

Urban living, your way.

jll.co.uk/residential

© 2019 Jones Lang LaSalle IP, Inc. All rights reserved. All information contained herein is from sources deemed reliable; however, no representation or warranty is made to the accuracy thereof.

